



reximex



throne Gen2 Series

PCP AIRGUN OWNERS MANUAL

.177 Cal. - .22 Cal. - .25 Cal

**READ ALL INSTRUCTIONS AND WARNINGS
IN THIS MANUAL BEFORE USING THIS AIRGUN**

INDEX



reximex

<u>Page</u>	<u>Content</u>
1	Warranty
1	Warning
2	Safety Review
3	General Instructions & Operating Safety
3	Manual Safety
4	Operating Instructions
4	A. <i>Filing The Air Cylinder</i>
5	B. <i>Loading The Airgun</i>
7	C. <i>Un-Loading & Un-Cocking The Airgun</i>
8	D. <i>Barrel Replacement</i>
8	E. <i>Power Adjustment</i>
10	F. <i>Jammed Ammo</i>
10	G. <i>Trigger Adjustment</i>
11	H. <i>Butt-Pad Adjustment</i>
11	I. <i>Cocking Lever Replacement</i>
12	J. <i>Maintenance</i>
12	K. <i>Storage</i>
13-14	Throne Mechanism & Part Numbers
15-16	Throne Compact Mechanism & Part Numbers

1. WARRANTY

All REXIMEX PCP Airguns carry a One Year Warranty against faulty workmanship and defective materials. Contact the dealer from which you purchased the airgun if it becomes necessary. If the airgun develops a defect within the warranty period, contact the dealer from whom it was purchased. The guarantee does not cover any damage caused by tampering with the airgun.

This airgun should only be disassembled by factory-authorized repairmen.

2. WARNING!

WARNING! NOT A TOY. THIS AIRGUN IS RECOMMENDED FOR ADULT USE ONLY. MISUSE OR CARELESS USE MAY CAUSE SERIOUS INJURY OR DEATH. MAY BE DANGEROUS UP TO 800 YARDS (732 METERS).

WARNING! DO NOT BRANDISH OR DISPLAY THIS AIRGUN IN PUBLIC. IT MAY CONFUSE PEOPLE AND MAY BE A CRIME.

DO NOT CHANGE THE COLORATION AND MARKINGS TO MAKE IT LOOK MORE LIKE A FIREARM. POLICE AND OTHERS MAY THINK IT IS A FIREARM AND IT MAY BE A CRIME.

YOU AND OTHERS NEXT TO YOU SHOULD ALWAYS WEAR SHOOTING GLASSES TO PROTECT YOUR EYES.

BUYERS AND USERS HAVE TO OBEY THE LAWS ABOUT THE USE AND OWNERSHIP OF THIS AIRGUN

**WARNING! NEVER ATTEMPT TO DISASSEMBLE THIS AIRGUN WHILE IT IS CHARGED!
FAILURE TO OBEY THIS INSTRUCTION COULD RESULT IN PERSONAL INJURY OR DAMAGE TO THE AIRGUN!**

3 SAFETY REVIEW

- Never use the airgun if you are intoxicated or under the influence of drugs.
- Even if there is no pressure sign on the manometer, never disassemble the pressurized tube!
- Never fire the airgun when it is empty of air or when the air cylinder is removed!
- Never point the airgun at anyone, or allow anyone to point a airgun at you!
- Treat every airgun as if it is loaded even if you know it is not loaded!
- Always carry the airgun so that the direction of the muzzle is under control, even if you stumble.
- Always be sure of your target and what lies behind it before firing your airgun.
- Never leave a loaded airgun unattended.
- Beware of targets that tend to cause ricochets.
- It is recommended that eye protection is worn when charging the air cylinder.
- Always use caution when operating this airgun.
- Only use dry cloth to clean any dirt inside the barrel for various reasons (humidity, dust, etc.)
- In your airgun, only use synthetic or mineral base high viscosity oil in order not to create filling effect with lower tolerance parts.
- Learn and obey the laws in your location.
- Be responsible in your use of this weapon!

REXIMEX PCP airguns are designed specifically for use with DRY COMPRESSED AIR. NO OTHER GAS OR GAS COMBINATION CAN BE USED.

The Airgun may be filled by a Diving Scuba Tank or a suitable compressor
MAXIMUM SAFE WORKING PRESSURE (SWP): 250 BAR



DANGER OF EXPLOSION!

THE AIR TANK POSES THE EXPLOSION RISK IF IT GETS HEATED SUBJECT TO SUNTRAY FOR EXTENDED PERIOD OF TIME.

(Max. + 40° / Min. -05°)

OTHERWISE, THE AIRGUN SHOULD BE LEFT TO COOL DOWN IN A COOL ENVIRONMENT
RECOMMENDED TO BE TRANSPORTED UNDER MAXIMUM 80 BARS PRESSURE DURING FLIGHTS.

4 GENERAL INSTRUCTIONS & OPERATING SAFETY

- REXIMEX Airguns should be fitted with a scope or alternate optic sights before use.
- Before using your airgun, read and abide by the basic safety rules.

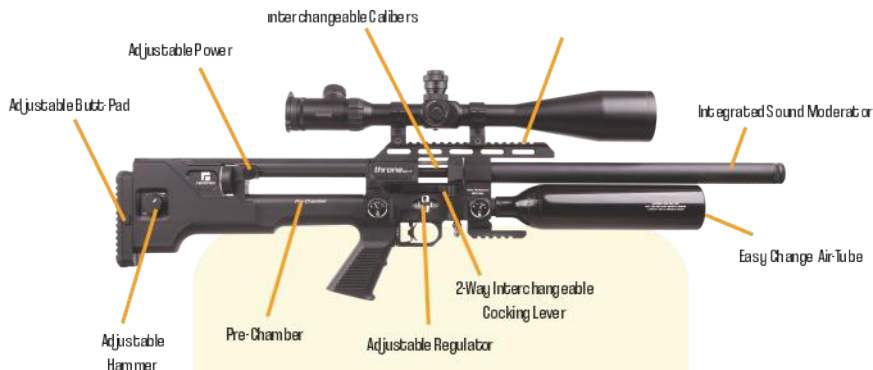

MANUAL SAFETY

CAUTION: Like all mechanical devices, airgun safety can fail. Even when the safety is on "SAFE" you should continue to handle the airgun in a safe manner.

Locate the safety switch of the airgun directly above the trigger guard. Safety switch can be set to "S" (SAFE) and "F" (FIRE) positions manually.

The Letters "S" (SAFE) and "F" (FIRE) are located below the trigger guard.

A- Airgun on "S" (SAFE) Position

To set the safety on, push the safety switch in up position below the trigger guard.

In this position the trigger cannot be pulled and the airgun cannot be fired.

B- Airgun on "F" (FIRE) Position

To set the safety off, push the safety switch in down position below the trigger guard.

In this position the trigger cannot be pulled and the airgun cannot be fired.



WARNING! KEEP THE AIRGUN IN THE "SAFE" POSITION UNTIL YOU ARE READY TO SHOOT. WHEN READY PUSH THE SAFETY SWITCH TO "FIRE" POSITION

5. OPERATING INSTRUCTIONS

A. FILLING THE AIR CYLINDER

1. Before filling the air cylinder; make sure the airgun is on "S" (SAFE) position, no pellets are loaded in the air airgun and/or barrel and magazine is not mounted in the gun.

NOTE: If the air cylinder pressure is at "0" Bar, then it will be necessary to cock the airgun to remove the force of the Hammer against the firing Valve. Otherwise, the air will pass through the firing Valve out the barrel, and the air cylinder will not pressurize.

2. Take all safety measures before filling the air cylinder. It is compulsory for the user and to wear eye & ear protection when filling the air cylinder.

3. While filling in the air cylinder; the pressure in the air cylinder must be monitored from the air gauge of the hand pump or scuba charging kit, Do not look at the air gauge on the air cylinder during filling process. Instead, reference the gauge on your fill device.

Assemble the filling equipment hose with the filling probe that is provided inside the box. Pull back on the outer sleeve on the quick connect fitting to release it from your airgun, when your tube is filled. If you hear **SOUND** of air during the first filling, move the probe and enable the O rings to be air-proof. (if the leakage continues, O rings might be deformed)



Overfill

In case of overfilling, BURST DISC is located on your airgun. This disc will tear if the air pressure on your airgun reaches to a dangerous level and this will prevent any potential over pressure danger.

In case the safety burst disc is born, a spare burst disc is included in your box and it needs to be changed.

B. LOADING THE AIRGUN

CAUTION: Never re-use ammunition.

Review the entire manual, including the section on Safety, before firing your airgun.

CAUTION: Know your airgun's loading mechanism for safest use! Pellets can either be loaded one by one using a single shot tray, or multiple pellets may be loaded using the rotary magazine. With the magazine placed correctly, EVERY action of closing the side lever WILL place a pellet into the chamber.

DO NOT TRY TO CLOSE THE SIDE LEVER WHEN THE MAGAZINE IS NOT LOADED!!!

Do not re-cock the airgun while there is pellet loaded inside the chamber!! This will load multiple pellets at the same time and may damage your airgun.

Removal of the magazine WILL still leave the chambered pellet in place unless the airgun is fired.

Loading the Magazine

Make sure your airgun is on "SAFE" position and is pointed to a SAFE DIRECTION.

If the magazine is fitted on the airgun, remove it to begin loading or unloading.

Move the clear cover over the catch point and rotate in the direction of the arrows (clockwise) Fig. A.

Place a finger under the magazine covering the hole, place the first pellet in the magazine nose first, make sure that the pellet does not protrude out of the magazine. If the pellet does protrude, simply push the pellet inward. Fig. B

Rotate the cover counterclockwise and place the remaining pellets into the magazine. Upon completion rotate the cover until it comes to rest. Fig. C

If it looks like Fig. D. The magazine is now ready for use.

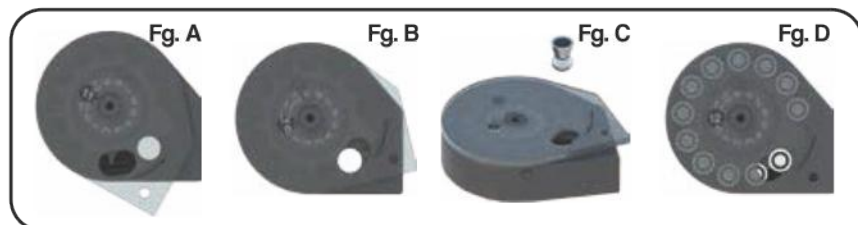

Placing the loaded Magazine on the Airgun & Firing Safety

NOTE: Following these directions will load your airgun and it will be ready to FIRE. Make sure your airgun is on "SAFE" position and is pointed to a SAFE DIRECTION.

- To fit the magazine into the airgun, pull the cocking handle backwards until it stops.
- With the cover of the magazine facing the butt of the airgun, insert the magazine from the right side and push it inward until it snaps into place.
- The line on the back of the magazine should align with the line on the loading slot of the airgun.

YOU WILL DAMAGE THE MAGAZINE IF IT IS NOT PLACED CORRECTLY

- Pull the cocking handle to its rear-most position.
- Push the cocking handle forward fully and ensure that it lays flat against the airgun in order to chamber a pellet.
- After following these steps and reading the entire manual, including the section of safety procedures, your airgun is now loaded and ready to fire.

DO NOT CLOSE THE COCKING HANDLE / MAGAZINE RELEASE BOLT UNTIL YOU ARE READY TO FIRE.

- Aim at your intended target and disengage the safety and prepare to shoot.
- Pull the trigger gently and the airgun will fire.
- To reload airgun, pull the cocking handle to its rear-most position. This will index the magazine and align the next pellet with the barrel. Then, repeat previous steps.



C. UN-LOADING & UN-COCKING THE AIRGUN

Un-loading & Removing the Magazine

1. Pulling the cocking handle to its rear-most position and Pushing it forward fully while the magazine is loaded will result in chambering a pellet.
2. To unload the airgun, it is recommended to fire the pellet in a SAFE DIRECTION.
3. Pull the side lever back to the rear position.

CAUTION. This action **WILL** cock the airgun.

4. Push the magazine out of the receiver from the left side.
5. Un-cock the airgun for safe storage.

Un-Cocking

When you are finished shooting, remove the magazine as instructed and un-cock the airgun by following the steps below:

1. Point the airgun in a SAFE DIRECTION.
2. Take the airgun on "FIRE" position.
3. Pull the cocking handle back to its rear-most position.
4. While firmly holding the cocking handle in the rear position, pull the trigger.
5. Continue to hold the trigger back while sliding the side lever forward to the latched position.
6. Release the trigger.
7. Put the airgun on "SAFE" position.

WARNING! EVEN THOUGH YOU FOLLOW THE UNLOADING PROCEDURE, CONTINUE TO TREAT THE AIRGUN AS IT IS LOADED. NEVER POINT THE AIRGUN AT ANYTHING YOU DO NOT INTEND TO SHOOT.

D. BARREL REPLACEMENT

1. First remove the barrel shroud. (Clockwise)
2. Remove the screw holding the barrel and pull out the barrel.
3. Remove the pellet pusher with the key included inside the box.
4. Attach the replacement caliber pellet pusher and tighten using the wrench. (Clockwise)
5. Then place the replacement caliber barrel.
6. Tighten the nut that holds the barrel.
7. Put the outer barrel back into place again and tighten. (Clockwise)

Make sure the pellet pusher and the barrel is the same caliber.



E. POWER ADJUSTMENT

Hammer Adjustment

Simply rotate the Hammer Spring Tension wheel while the air gun is un-cocked in the either direction and set the desired hammer tension level.



Valve Adjustment

Simply rotate the power knob while the airgun is un-cocked in the "+" or "-" direction and set the desired power level



Regulator Adjustment

Regulator pressure may be raised (+) at any time including when there is air in the system.

- Raise the regulator pressure by simply twisting the wheel in (+) direction.



ATTENTION! DO NOT LOWER (-) REGULATOR PRESSURE BEFORE COMPLETELY RELEASING THE AIR IN THE SYSTEM (INCLUDING THE REGULATOR & PRE-CHAMBER)

IF YOU DO, YOUR AIRGUN MIGHT BE DAMAGED AND WARRANTY WILL BE VOID!!

ATTENTION! There may be air leakage when removing the tube.

To release the air in the Regulator & pre-chamber, pull the cocking lever and push the trigger. (Continue this process until the air in the regulator is completely released.)

1. Remove the Air tube or De-gas air in the system completely.
2. Make sure both Gauges are at 0 bar (psi)
3. Lower the regulator pressure by simply twisting the wheel all the way in (-) direction with Allen wrench.
4. Fill with air before raising regulator pressure slowly to requested level.

F. JAMMED AMMO

A jammed ammo is usually caused by firing the airgun when the air pressure is too low. Please, do not operate your airgun below 100 bar (1500 PSI) air pressure.

CAUTION: Never try to look through the barrel to see if a jammed ammo is cleared.

Make sure the airgun is on "SAFE" position and pointed in a SAFE DIRECTION.

- Pull the cocking handle back to its rear-most position.
- Insert a clearing rod of the proper size into the barrel, starting from the muzzle (Barrel may be damaged if the clearing rod is not proper size)

NOTE: Cocking handle must be at its rear-most position for the jammed ammo to clear the breech when it is pushed out by the ramrod.

- Push or tap ammo towards the breech end of the barrel until the pellet is extracted from the chamber.
- Operate carefully in order not to damage the chamber sealing O-ring.
- Remove and discard the ammo.
- Do not reuse that ammo.

If you are not successful removing the jammed ammo following above instructions, take no further action. REXIMEX Technical Service or an Authorized Service Station will unjam your airgun (Free of charge during the warranty period).

G. TRIGGER ADJUSTMENT

- First, remove the grip area using an Allen wrench. (Bottom of the grip)
- After removing the grip area successfully, trigger sensitivity adjustment may be done using an Allen wrench as shown on the picture.
- Re-mount the grip using the Allen wrench.



H. BUTT-PAD ADJUSTMENT

- Adjust up and down with the help of the buttons on the side of the pad.



WARNING! DO NOT MODIFY OR ALTER YOUR AIRGUN. ATTEMPTS TO MODIFY THE AIRGUN IN ANY WAY INCONSISTENT WITH THIS MANUAL MAY MAKE YOUR AIRGUN UNSAFE TO USE, CAUSE SERIOUS INJURY OR DEATH, AND WILL MAKE THE WARRANTY INACTIVE.

WARNING! DO NOT ATTEMPT TO REPAIR YOUR AIRGUN OR TO DISASSEMBLE TO CORRECT AN OVER-FILL OR VALVE LOCK. PARTS MAY FLY OUT FROM THE AIRGUN AT DANGEROUS SPEEDS IF IT IS DISASSEMBLED WHILE PRESSURIZED.

I. COCKING LEVER REPLACEMENT

1. Remove the cover of the cocking lever.
2. Remove the barrel shroud. (Clockwise)
3. Remove the nut that holds the barrel and disassemble the barrel.
4. Remove the top cover on the other side.
5. Remove the picatinny rail on the top.
6. Remove the side screws on the body.
7. Remove the rear side by sliding the top body.
8. Remove the screw that holds the cocking lever with a screwdriver.
9. After switching the side of the cocking lever, replace the screw.

J. MAINTENANCE

- Apply Reximex silicone chamber oil on the barrel breech and O-rings every 3 months or 500 shots.
- Periodically check your air gun. If anything feels different, like a shorter or weaker trigger pull, this may mean worn out or broken parts, call Reximex customer service for assistance before re-using your air gun.

REPLACEMENT OF O-RINGS

After a period of time, the O-rings on the fill probe will need to be replaced. The need for this will become noticeable if air is heard leaking from the nozzle while charging the air gun.

LUBRICANT

General: Keep the air gun clean and wipe it off with regular gun oil and a cloth occasionally.

Fill probe: Apply a thin layer of suitable mineral based oil occasionally or when dried out.

Magazines: Apply a thin layer of suitable mineral based oil occasionally or when dried out.

Cocking handle and Sidelever Sliding Surface: Apply a thin layer of a standard multipurpose grease occasionally or when dried out.

WARNING: Never use grease or spray oil in the moving parts inside the gun.

This can result in unstable power and also leakage. Be moderate with lubricant.

K. STORAGE

Store in a place that is dry and dark. Store with air pressure between 50-100 bar in the air gun.

WARNING!

- Keep away from spaces with high humidity as steel parts might corrode.
- Keep away from bright sunlight as this shortens the life of the O-rings.
- Never store the air gun loaded with pellets.

Please Visit www.reximex.com for more information & "How to?" videos.

PART LIST

Parça Kodu / Part Code	Part Name
TG2 -4-1	Throne Cocking Lever Stopper
TG2 -4-2	Pellet Pusher Carrier
TG2 -4-3	Pellet Pusher Block
TG2 - 4-4*	Throne Pellet Pusher Tip*
TG2 -4-5	Throne Vertical Connection Rod Guide
TG2 -4-6	Throne Hammer Spring Capsule
TG2 -4-7	Throne Hammer Spring
TG2 -4-8	Throne Hammer
TG2 -4-9	Throne Hammer Side Screw
TG2 -4-10	Throne Spring Tension Adjuster Button
TG2 -4-11	Throne Spring Tension Adjuster Spring
TG2 -4-12	Throne Barrel Fix Screw
BTB -1-3	Trigger Finger Piece Rod Base Spring
TG2 -4-14	Trigger Finger Piece Rod Base
BTB -1-7	Hammer Holder Spring
BTB -1-6	Hammer Holder
BTB -1-5	Trigger Lever
BTB -1-8	Hammer Holder Sear
BTB -1-9	Hammer Holder Sear Spring
TG2 -4-20	Throne Trigger Group Spring Base
TG2 -4-21	Throne Trigger Rod Bridge
TG2 -4-22	Throne Power Adjustment Valve
TG2 -4-23	Throne Power Adjustment Valve Catch Spring
TG2 -4-24	Throne Spring Tension Adjuster
TG2 -4-25	Throne Cocking Lever Rod
TG2 -4-26	Throne Vertical Connection Rod
TG2 -4-27	Throne Rear Chassis
TG2 -4-28	Throne Checkrest
TG2 -4-29	Throne Hammer Spring Tension Adjuster Catch
BC-003	M3x12 Hexagon Socket Button Head Screw (ISO-7380)
AA-006	2x10 Parallel Pin (ISO-8734)
AA-003	2x5 Parallel Pin (ISO-8734)
AA-004	M3x5 Flat Point SetScrew (ISO-4026)
AA-005	M3x6 Flat Point SetScrew (ISO-4026)
AA-009	M3x10 Flat Point SetScrew (ISO-4026)
AA-007	3x24 Parallel Pin (ISO-8734)
AA-008	2x14 Parallel Pin (ISO-8734)
AA-002	2x5 Parallel Pin (ISO-8734)
JR-002	M5x7 Ball Point SetScrew
3B-011	M5x16 Socket Countersunk Head Screw (ISO-10642)
2A-008	O-Ring - 4x1.5 NBR70
TG2 - 2-1	Throne Barrel*
RN -3-6	Reximex Integrated Moderator Core
2A-012	O-Ring - 5.5x1.5 NBR70*
2A-014	O-Ring - 8x1.5 NBR70
2A-029	O-Ring - 18x4 NBR70
R-MAG -1-2	Reximex Magazine*
RN -3-3	UNF 1/2" Thread Protector
TG2 -5-1	Throne Gen2 Shroud
ZB-017	O-Ring - 9x2 NBR90
ITB -1-1	Air Bottle Tap
ZB-030	O-Ring - 18.73x2.62 NBR90
ZB-008	O-Ring - 4x1.5 NBR90
ITB -1-2	Air Bottle Valve
ITB -1-3	Air Bottle Valve Spring
ITB -1-4	Air Bottle Valve Spring Base
ATT -1-1	J25C6 Air Bottle
2A-015	O-Ring - 5x1 NBR70
TG -3-2	Throne Hammer Valve Polymer Seal
2A-004	O-Ring - 3x1 NBR70
TG -3-3	Throne Hammer Valve
TG -3-4	Throne Hammer Valve Spring
TG -3-5	Throne Hammer Valve Spring Base
ZB-001	014 Snapping (DH472)
ZB-017	O-Ring - 9x2 NBR90
RR -1-3	Reximex Regulator Valve
RR -1-6	Reximex Regulator Valve Polymer Pad
2A-005	O-Ring - 3x1.5 NBR70
RR -1-7	Reximex Regulator Disk Spring
2A-025	O-Ring - 15.5x2 NBR70
TG2 -3-11	Throne Regulator Body
ZB-006	O-Ring - 3x2 NBR90

Parça Kodu / Part Code	Part Name
TG2 -3-12	Throne Regulator Outer Screw
TG2 -3-13	Throne Regulator Inner Screw
2A-002	O-Ring - 2x1.5 NBR70
2A-026	O-Ring - 16x2 NBR70
TG2 -3-1	Throne Pre-Chamber Rear Tap
2A-031	O-Ring - 19x2 NBR70
2A-024	O-Ring - 15x2 NBR70
TG2 -3-6	Pre Chamber
TG2 -3-7	Throne Pre-Chamber Front Tap
2A-027	O-Ring - 18x2 NBR70
TG2 -3-46	Throne Cocking Lever Rear Pin
2A-023	O-Ring - 14x2 NBR70
3A-009	M4x6 Socket Head Screw (ISO-10642)
3A-020	M5x8 Socket Head Screw (ISO-10642)
TG2 -3-47	Throne Top Picatinny
TG2 -3-52	Throne Cocking Lever Side Cover
TG2 -3-44	Throne Rod Carrier Block
TG2 -3-45	Throne Cocking Lever Front Pin
3B-002	M3x6 Socket Countersunk Head Screw (ISO-10642)
TG2 -3-41	Throne Cocking Lever Link Housing
TG2 -3-42	Throne Counter Spring
TG2 -3-43	Throne Counter Spring Base
2A-005	O-Ring - 3x1.5 NBR70
2A-014	O-Ring - 8x1.5 NBR70
TG2 -3-39	Throne Regulator Check-Valve
TG2 -3-40	Throne Air Bottle Coupler (ZE)
5C-003	M12 Bonded Seal
TG2 -3-49	Throne Front Chassis
5C-002	M5 Bonded Seal
DC -1-1	Thin Seal
EMS -1-2	Burst Disk
EMS -1-1	Burst Disk Screw
DC -1-2	Thick Seal
DJ -0-3	Filling Port Rear Cap
DJ -0-4	Filling Port Spring
ZB-005	O-Ring - 3x1.5 NBR90
DJ -0-2	Filling Port Valve
DJ -1-1	Filling Port
4A-014	2.5x12 Parallel Pin (ISO-8734)
TG2 -3-48	Throne Lower Picatinny
3A-021	M5x10 Socket Head Screw (ISO-10642)
TG2 -3-23	Regulator Adjustment Knob
4A-010	2x18 Parallel Pin (ISO-8734)
4A-009	2x16 Parallel Pin (ISO-8734)
TG2 -3-28	Throne Safety Catch Spring
TG2 -3-29	Throne Safety Catch
TG2 -3-51	Throne Trigger Finger Piece Rod Housing
TG2 -3-26	Throne Trigger Finger Piece Rod
1A-002	M3x3 Flat Point SetScrew (ISO-4026)
RTB -1-4	Trigger Finger Piece
TG2 -3-24	Trigger Protection Cover
TG2 -3-30	Throne Safety Button
7A-001	d2.5 Outer Snapping
5A-001	M3 Plain Washer (ISO-7089)
TG2 -3-14	Trigger Rod Spring
TG2 -3-15	Throne Trigger Rod
RKS -1-20	Cocking Lever Link Rear Screw
TG2 -3-53	Cocking Lever Bushing
TG2 -3-16	Cocking Lever
3B-016	M5x16 Socket Countersunk Head Screw (ISO-10642)
TG2 -3-19	Cocking Lever Link
TG2 -3-17	Cocking Lever Handgrip
RB -1-1	Airtube Barometer
RB -1-2	Regulator Barometer
TG2 -6-1	Throne Synthetic Stock
TG2 -6-2	Throne Butt-pad Adjustment Button Spring
TG2 -6-3	Throne Butt-Pad
TG2 -6-4	Throne Butt-pad Mover Part
TG2 -6-5	Throne Butt-Pad Adjustment Button
TG2 -6-6	Throne Handgrip Lid
3A-022	M5x12 Socket Head Screw (ISO-10642)
3A-031	M6x20 Socket Head Screw (ISO-10642)
5B-001	M6 Serrated Lock Washer (ISO-6798)

Please explicitly specify following information when ordering spare parts:
1) "Part Code" that's seen in this drawing
2) "Calliber" information on the right top corner of the page)
3) "Calliber" information for parts with an "*"

Drawn On: Apr 14th, 2022
Resim Terhhi: 14 Nisan 2022

* Please explicitly specify Calliber when ordering following parts:

102-4-5	102-5-5	102-6-5	102-7-5	102-8-5	102-9-5	102-10-5	102-11-5	102-12-5	102-13-5
102-4-5	102-5-5	102-6-5	102-7-5	102-8-5	102-9-5	102-10-5	102-11-5	102-12-5	102-13-5

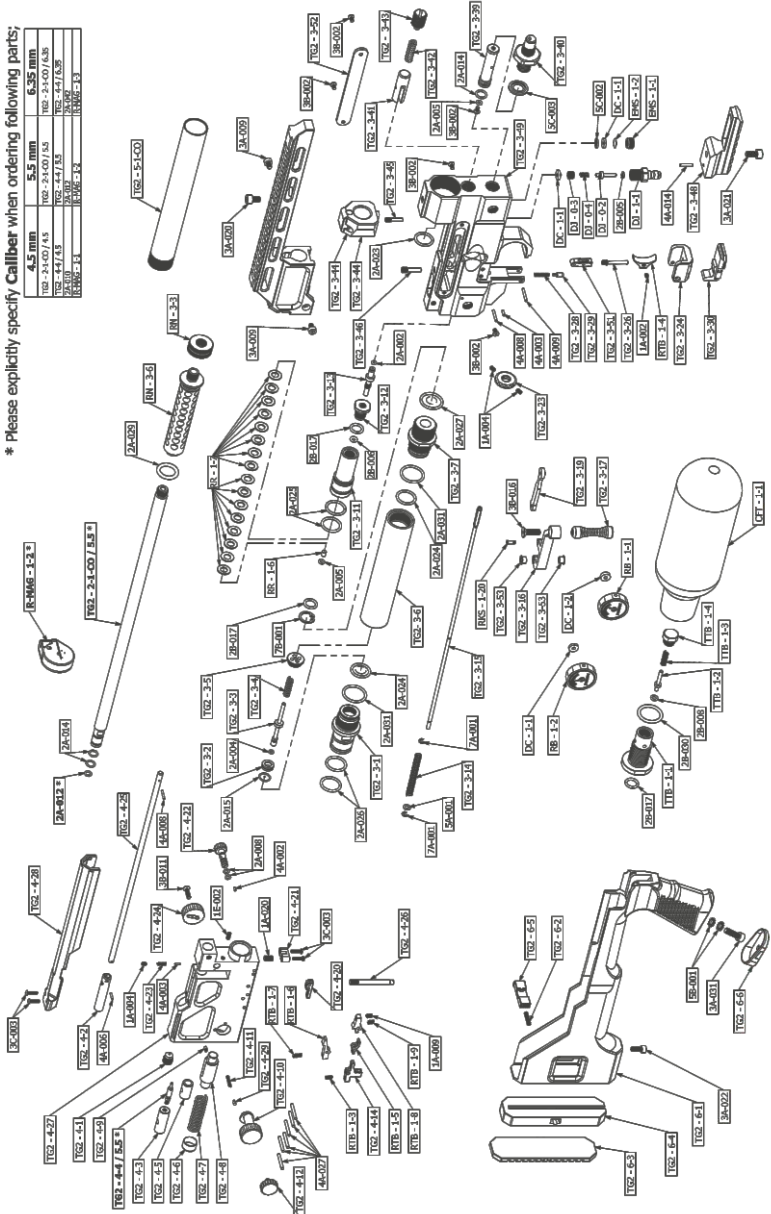

Parça Kodu / Part Code	Part Name	Parça Kodu / Part Code	Part Name
TG2 - 4-1	Throne Cocking Lever Stopper	TG2 - 3-12	Throne Regulator Outer Screw
TG2 - 4-2	Pellet Pusher Carrier	TG2 - 3-13	Throne Regulator Inner Screw
TG2 - 4-3	Pellet Pusher Block	2A-002	O-Ring - 2x1.5 NBR70
TG2 - 4-4*	Throne Pellet Pusher Tip*	2A-026	O-Ring - 16x2 NBR70
TG2 - 4-5	Throne Vertical Connection Rod Guide	TG2 - 3-1	Throne Pre-Chamber Rear Tap
TG2 - 4-6	Throne Hammer Spring Capsule	2A-031	O-Ring - 19x2 NBR70
TG2 - 4-7	Throne Hammer Spring	2A-024	O-Ring - 15x2 NBR70
TG2 - 4-8	Throne Hammer	TG2 - 3-6	Pre Chamber
TG2 - 4-9	Throne Hammer Side Screw	TG2 - 3-7	Throne Pre-Chamber Front Tap
TG2 - 4-10	Throne Spring Tension Adjuster Button	2A-027	O-Ring - 18x2 NBR70
TG2 - 4-11	Throne Spring Tension Adjuster Spring	TG2 - 3-46	Throne Cocking Lever Rear Pin
TG2 - 4-12	Throne Barrell Fix Screw	2A-023	O-Ring - 14x2 NBR70
RTB - 1-3	Trigger Finger Piece Rod Base Spring	3A-009	M3x6 Socket Head Screw (ISO-10642)
TG2 - 4-14	Trigger Finger Piece Rod Base	3A-020	M5x8 Socket Head Screw (ISO-10642)
RTB - 1-7	Hammer Holder Spring	TG2 - 3-47	Throne Top Picatinny
RTB - 1-6	Hammer Holder	TG2 - 3-52	Throne Cocking Lever Side Cover
RTB - 1-5	Trigger Lever	TG2 - 3-44	Throne Rod Carrier Block
RTB - 1-8	Hammer Holder Sear	TG2 - 3-45	Throne Cocking Lever Front Pin
RTB - 1-9	Hammer Holder Sear Spring	3B-002	M3x6 Socket Countersunk Head Screw (ISO-10642)
TG2 - 4-20	Throne Trigger Group Spring Base	TG2 - 3-41	Throne Cocking Lever Link Housing
TG2 - 4-21	Throne Trigger Rod Bridge	TG2 - 3-42	Throne Counter Spring
TG2 - 4-22	Throne Power Adjustment Valve	TG2 - 3-43	Throne Counter Spring Base
TG2 - 4-23	Throne Power Adjustment Valve Catch Spring	2A-005	O-Ring - 3x1.5 NBR70
TG2 - 4-24	Throne Spring Tension Adjuster	2A-014	O-Ring - 8x1.5 NBR70
TG2 - 4-25	Throne Cocking Lever Rod	TG2 - 3-39	Throne Regulator Check-Valve
TG2 - 4-26	Throne Vertical Connection Rod	TG2 - 3-40	Throne Air Bottle Coupler (2E)
TG2 - 4-27	Throne Rear Chassis	5C-003	M12 Bonded Seal
TG2 - 4-28	Throne Cheekrest	TG2 - 3-49	Throne Front Chassis
TG2 - 4-29	Throne Hammer Spring Tension Adjuster Catch	5C-002	M5 Bonded Seal
3C-003	M3x12 Hexagon Socket Button Head Screw (ISO-7380)	DC - 1-1	Thin Seal
4A-006	2x10 Parallel Pin (ISO-8734)	EMS - 1-2	Burst Disk
4A-003	2x6 Parallel Pin (ISO-8734)	EMS - 1-3	Burst Disk Screw
4A-004	M3x5 Flat Point SetScrew (ISO-4026)	DC - 1-2	Thick Seal
4A-005	M3x6 Flat Point SetScrew (ISO-4026)	DI - 0-3	Filling Port Rear Cap
4A-020	M6x10 Flat Point SetScrew (ISO-4026)	DI - 0-4	Filling Port Spring
4A-027	3x24 Parallel Pin (ISO-8734)	2B-005	O-Ring - 3x1.5 NBR90
4A-008	2x14 Parallel Pin (ISO-8734)	DI - 0-2	Filling Port Valve
4A-002	2x5 Parallel Pin (ISO-8734)	DI - 1-1	Filling Port
1E-002	M5x7 - Ball Point SetScrew	4A-014	2.5x12 Parallel Pin (ISO-8734)
3B-011	M4x16 Socket Countersunk Head Screw (ISO-10642)	TG2 - 3-48	Throne Lower Picatinny
2A-008	O-Ring - 4x1.5 NBR70	3A-021	M5x10 Socket Head Screw (ISO-10642)
TG2 - 2-1-CO	Throne Compact Barrell*	TG2 - 3-23	Regulator Adjustment Knob
RN - 3-6	Reximex Integrated Moderator Core	4A-010	2x18 Parallel Pin (ISO-8734)
2A-012	O-Ring - 5.5x1.5 NBR70 *	4A-009	2x16 Parallel Pin (ISO-8734)
2A-014	O-Ring - 8x1.5 NBR70	TG2 - 3-28	Throne Safety Catch Spring
2A-029	O-Ring - 18x4 NBR70	TG2 - 3-29	Throne Safety Catch
R-MAG - 1-2	Reximex Magazine*	TG2 - 3-51	Throne Trigger Finger Piece Rod Housing
RN - 3-3	UNF 1/2" Thread Protector	TG2 - 3-26	Throne Trigger Finger Piece Rod
TG2 - 5-1-CO	Throne Compact Shroud	1A-002	M3x3 Flat Point SetScrew (ISO-4026)
2B-017	O-Ring - 9x2 NBR90	RTB - 1-4	Trigger Finger Piece
TTB - 1-1	Air Bottle Tap	TG2 - 3-24	Trigger Protection Cover
2B-030	O-Ring - 18.72x2.62 NBR90	TG2 - 3-30	Throne Safety Button
2B-008	O-Ring - 4x1.5 NBR90	7A-001	Ø2.5 Outer Snapping
TTB - 1-2	Air Bottle Valve	5A-001	M3 Plain Washer (ISO-7089)
TTB - 1-3	Air Bottle Valve Spring	TG2 - 3-14	Trigger Rod Spring
TTB - 1-4	Air Bottle Valve Spring Base	TG2 - 3-15	Throne Trigger Rod
CFT - 1-1	300cc Carbonfiber Air Bottle	RKS - 1-20	Cocking Lever Link Rear Screw
2A-015	O-Ring - 9x1 NBR70	TG2 - 3-53	Cocking Lever Bushing
TG - 3-2	Throne Hammer Valve Polymer Seal	TG2 - 3-16	Cocking Lever
2A-004	O-Ring - 3x1 NBR70	3B-016	M5x1F Socket Countersunk Head Screw (ISO-10642)
TG - 3-3	Throne Hammer Valve	TG2 - 3-19	Cocking Lever Link
TG - 3-4	Throne Hammer Valve Spring	TG2 - 3-17	Cocking Lever Handgrip
TG - 3-5	Throne Hammer Valve Spring Base	RB - 1-1	Airtube Barometer
7B-001	D14 Snapping (DIN472)	RB - 1-2	Regulator Barometer
2B-017	O-Ring - 9x2 NBR90	TG2 - 6-1	Throne Synthetic Stock
RR - 1-3	Reximex Regulator Valve	TG2 - 6-2	Throne Butt-tpad Adjustment Button Spring
RR - 1-6	Reximex Regulator Valve Polymer Pad	TG2 - 6-3	Throne Butt-Pad
2A-005	O-Ring - 3x1.5 NBR70	TG2 - 6-4	Throne Butt-tpad Mover Part
RR - 1-7	Reximex Regulator Disk Spring	TG2 - 6-5	Throne Butt-Pad Adjustment Button
2A-025	O-Ring - 15.5x2 NBR70	TG2 - 6-6	Throne Handgrip Lid
TG2 - 3-11	Throne Regulator Body	3A-022	M5x12 Socket Head Screw (ISO-10642)
2B-006	O-Ring - 3x2 NBR90	3A-031	M6x20 Socket Head Screw (ISO-10642)
		5B-001	M6 Serrated Lock Washer (ISO-6798)



 **reximex**

ORIGINAL
MADE IN TURKEY
ORIGINAL



REXIMEX İt. İh. Av Malz. Sav. San. Tic. Ltd. Şti.

 Bayaşehir Mahallesi 41958. Sokak No:3 Beyşehir / Konya

 0332 511 0055  export@reximex.com

 www.reximex.com



/Reximexarms



/Reximexarms



/Reximexarms