



# CALDWELL™

# CLAYMORE™

## CLAY TARGET THROWER

INSTRUCTIONS & SAFETY INFORMATION

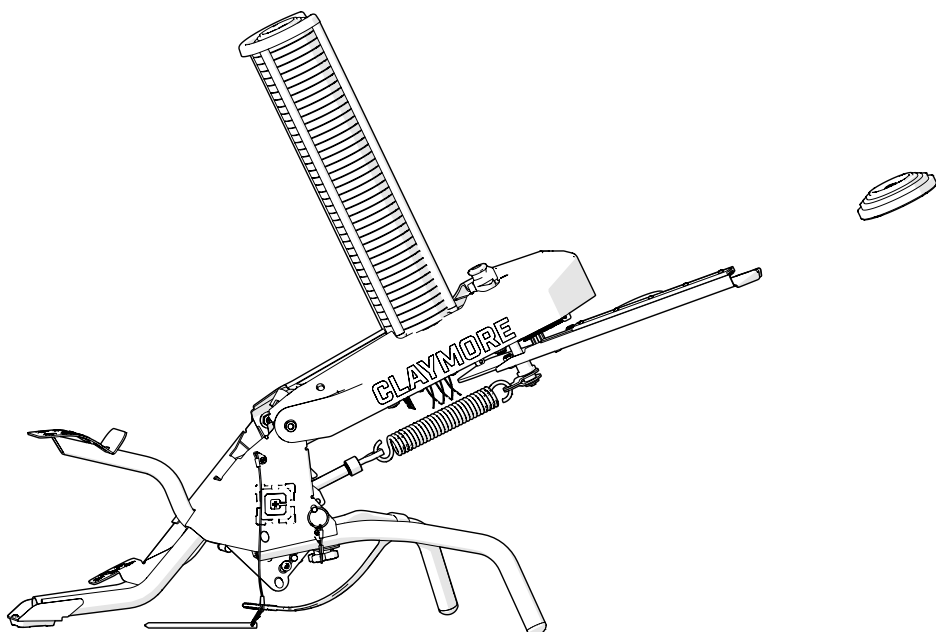

**⚠ WARNING: REVIEW AND UNDERSTAND ALL INSTRUCTIONS BEFORE USING THIS PRODUCT**

📺 INSTRUCTIONAL VIDEO: <https://www.caldwellshooting.com/claymore-instructions/>



# TABLE OF CONTENTS

|  |              |
|--|--------------|
| <b>SAFETY WARNINGS</b>                       | <b>4</b>     |
| <b>GETTING TO KNOW YOUR CLAYMORE</b>         | <b>5</b>     |
| <b>SETUP</b>                                 | <b>6–11</b>  |
| <b>OPERATION</b>                             | <b>12–14</b> |
| Loading Clays                                |              |
| Throwing Clays                               |              |
| Manual Mode                                  |              |
| Flurry Mode                                  |              |
| Unloading Clays                              |              |
| Adjusting the Throwing Distance and Angle    |              |
| Removing Main Spring Tension                 |              |
| Throwing Distance Adjustment                 |              |
| Throwing Angle Adjustment                    |              |
| <b>STORAGE</b>                               | <b>15</b>    |
| Folding                                      |              |
| Transporting                                 |              |
| Storing                                      |              |
| <b>TROUBLESHOOTING</b>                       | <b>16–18</b> |
| Arm Does Not Rotate When Expected            |              |
| Excessive Broken Targets                     |              |
| Low Quality or Wrong Targets                 |              |
| High Spring Tension                          |              |
| Debris Lodged Under the Arm Bumper           |              |
| Bent Brushes                                 |              |
| Damaged Arm Bumper                           |              |
| Worn or Damaged Wear Components              |              |
| Squeaking Joints                             |              |
| <b>MAINTENANCE</b>                           | <b>19–23</b> |
| Replacing the Side Brushes                   |              |
| Replacing the Back Brushes and Clay Retainer |              |
| Replacing the Arm Bumper                     |              |
| Replacing the Arm Stop Damper                |              |

# **⚠ READ BEFORE BEGINNING**

## **⚠ WARNING**

**READ, UNDERSTAND, AND FOLLOW ALL INSTRUCTIONS BEFORE USE. FAILURE TO DO SO MAY RESULT IN SERIOUS INJURY OR DEATH.**

**ALWAYS TREAT THE CLAYMORE AS ARMED AND DANGEROUS UNTIL THE SAFETY PIN HAS BEEN INSTALLED AND THE SPRING TENSION HAS BEEN REMOVED.**

**ALWAYS INSTALL THE SAFETY PIN BEFORE LOADING CLAYS OR MAKING ADJUSTMENTS. ALWAYS INSTALL THE SAFETY PIN WHEN NOT ACTIVELY THROWING CLAYS.**

**STAY BEHIND THE CLAYMORE AND OUTSIDE THE PATH OF THE THROWING ARM UNLESS THE SAFETY PIN IS INSTALLED.**

**ALWAYS KEEP ALL BODY PARTS AWAY FROM THE PATH OF THE THROWING ARM.**

**THE CLAYMORE IS CAPABLE OF THROWING TARGETS A DISTANCE OF OVER 75 YARDS, ESPECIALLY DURING WINDY CONDITIONS. USE ONLY IN AREAS WHERE THERE IS NO RISK OF CAUSING INJURY TO ANOTHER PERSON OR DAMAGE TO PROPERTY.**

**KNOW YOUR BACKSTOP. ENSURE THERE IS A SAFE PERIMETER THROUGHOUT TARGET FLIGHT PATH SUFFICIENT FOR CLAYS AND AMMUNITION USED.**

**ONLY USE THE CLAYMORE IN AREAS THAT ALLOW SAFE ACCESS TO ALL PARTS OF THE CLAYMORE, INCLUDING THE BACK OF THE UNIT, THE SERVICE KNOB, AND THE SAFETY PIN.**

**UTILIZE THE OPERATE/SERVICE KNOB AND SAFETY PIN DURING LOADING AND USE.**

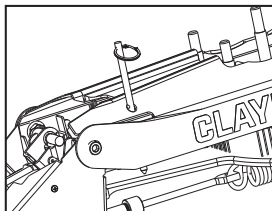

**SAFETY PIN INSTALLED  
INCORRECTLY**

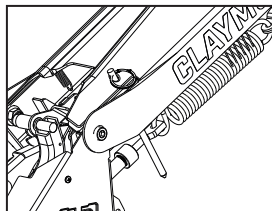

**SAFETY PIN INSTALLED  
CORRECTLY**

**⚠ WARNING: STAY CLEAR OF THE ARM'S PATH WHEN REMOVING THE SAFETY PIN AS THE ARM MAY ROTATE.**

# GETTING TO KNOW YOUR CLAYMORE

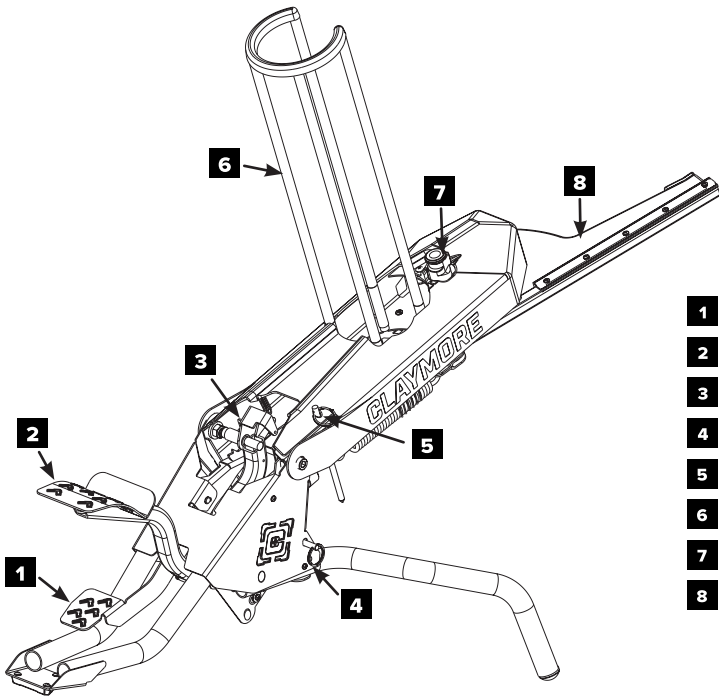

- 1** FIRE PEDAL
- 2** CHARGE PEDAL
- 3** FLURRY SELECTOR
- 4** TILT LOCK PIN
- 5** SAFETY PIN
- 6** CLAY HOPPER
- 7** SERVICE KNOB
- 8** THROWING ARM

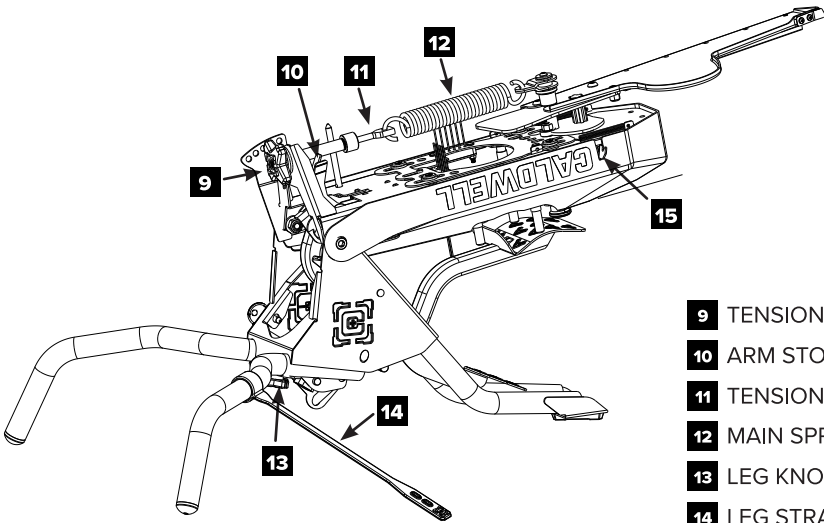

- 9** TENSION KNOB
- 10** ARM STOP
- 11** TENSION ROD
- 12** MAIN SPRING
- 13** LEG KNOB
- 14** LEG STRAP
- 15** LATCHING PEG
- 16** HEAD ASSEMBLY

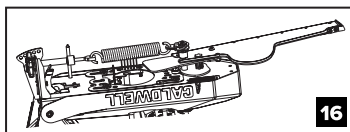

# SETUP

● PLEASE WATCH THE CLAYMORE INSTRUCTIONAL VIDEO AT:  
<https://www.caldwellshooting.com/claymore-instructions/>

1. Turn the LEG KNOB counterclockwise several times to allow the leg-retaining plate enough clearance to rotate 90 degrees; allowing legs to be extended from their folded position.

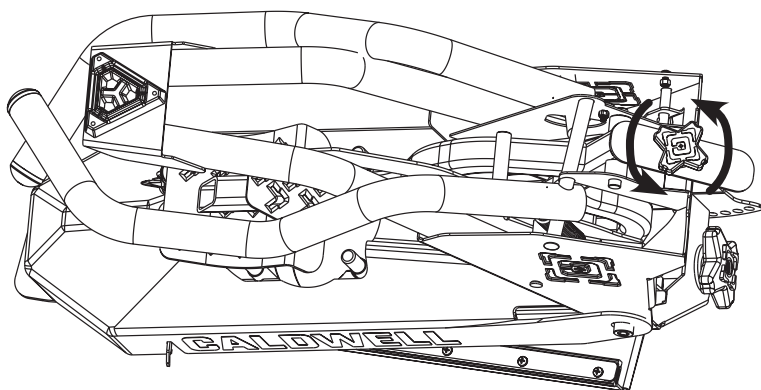

2. Pull down and out on the end of the LEG STRAP to release it from the hooked position.

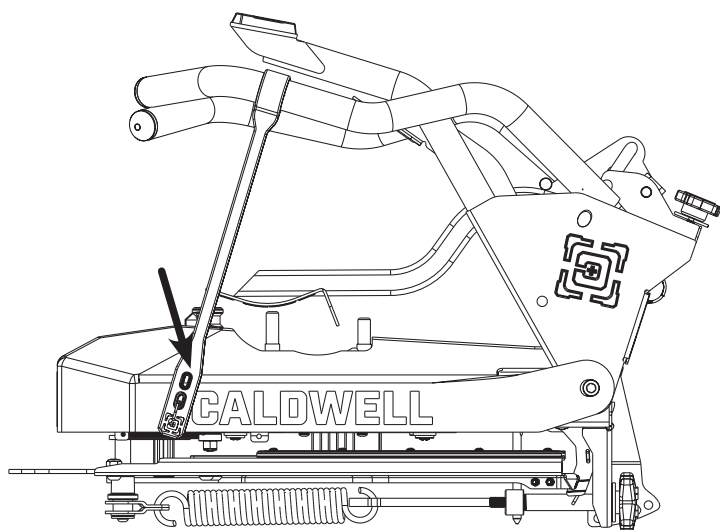

# SETUP

3. Rotate the legs forward until they rest against the metal frame.

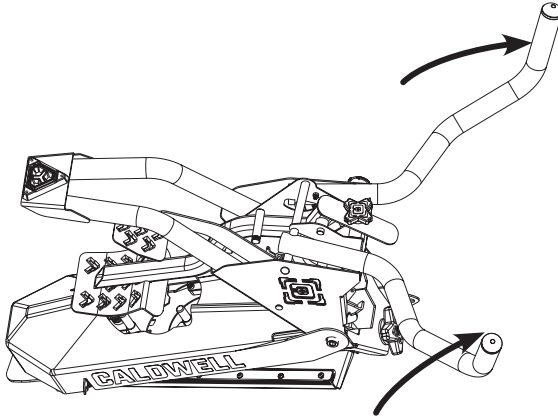

4. Rotate the leg-retaining plate to the horizontal position and turn the LEG KNOB clockwise until tightened.

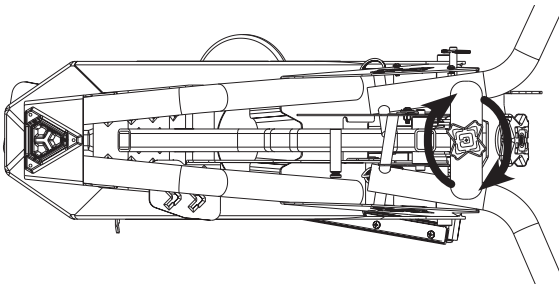

5. Rotate the entire Claymore over so it rests on its legs.

**CAUTION: THE HEAD ASSEMBLY IS FREE TO ROTATE ABOUT THE BASE AND MAY MOVE UNEXPECTEDLY IF NOT PROPERLY RESTRAINED.**

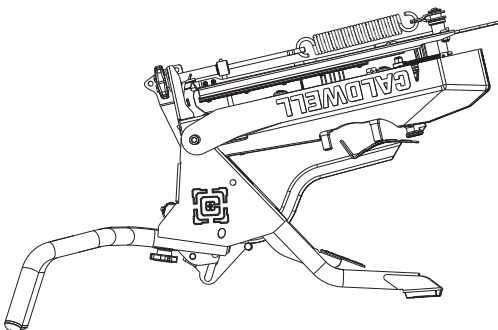

# SETUP

6a. Rotate HEAD ASSEMBLY completely forward. Remove the SAFETY PIN.

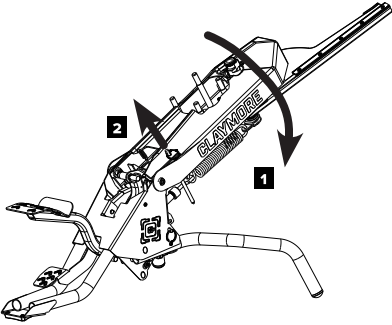

6b. Rotate back to original position.

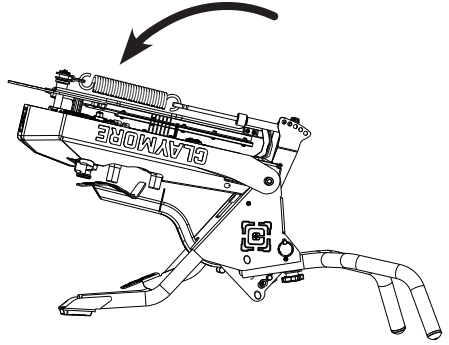

7a. Push back the ARM STOP to release the arm.

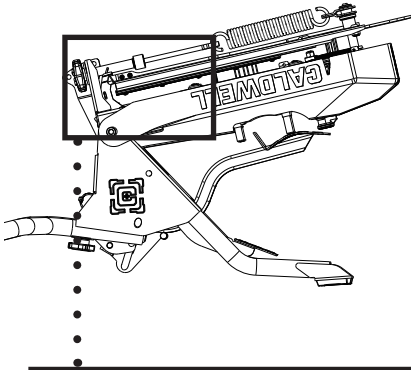

7b. Let go of the ARM STOP and rotate the arm clockwise a full rotation.

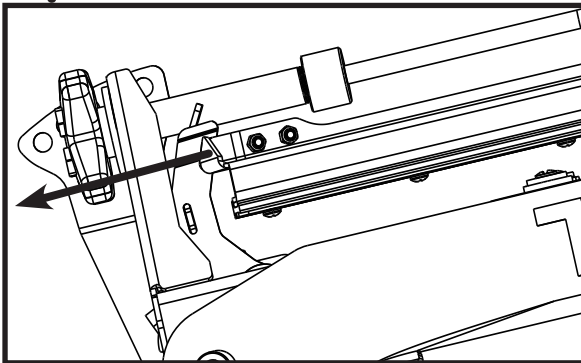
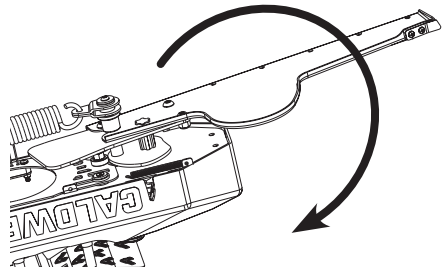

# SETUP

8. Verify the bottom edge of the THROWING ARM is in between the two grooves located on the ARM STOP as shown below. If it is not between the grooves, gently bend the arm to align it.

**⚠ WARNING: IF THE ARM IS NOT IN BETWEEN THE GROOVES, THE CLAYMORE WILL NOT THROW PROPERLY AND MAY RESULT IN SERIOUS INJURY, OR DAMAGE TO THE CLAYMORE.**

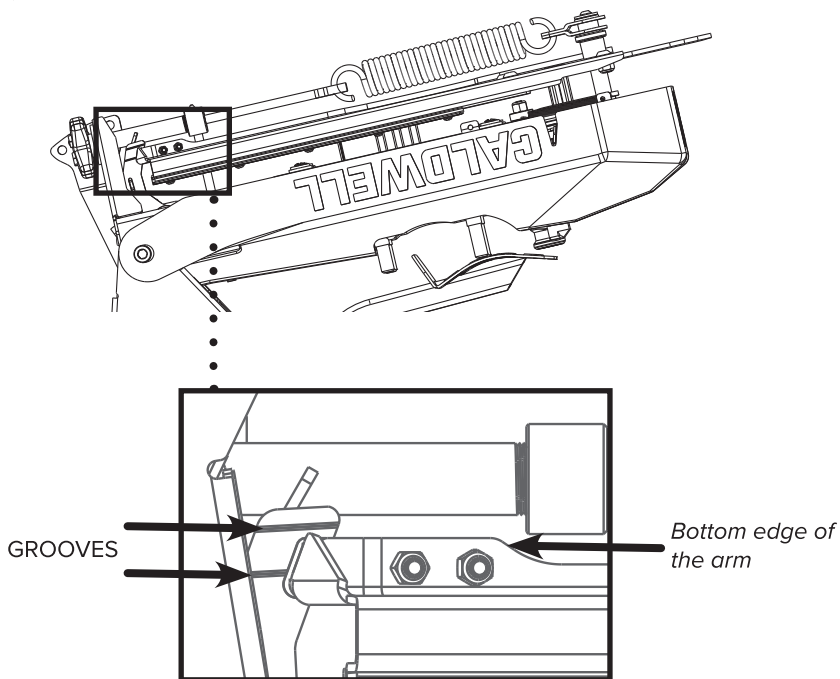

- 9a. Push back the ARM STOP (reference 7a for image).

- 9b. With the ARM STOP pulled back, rotate the arm clockwise to the location shown in the image for step 10.

# SETUP

10. To tighten the MAIN SPRING, rotate the TENSION KNOB clockwise while pulling the TENSION KNOB and MAIN SPRING towards one another. Rotate the TENSION KNOB until all slack is removed between the TENSION KNOB and MAIN SPRING. Then rotate the TENSION KNOB an additional 5 rotations.

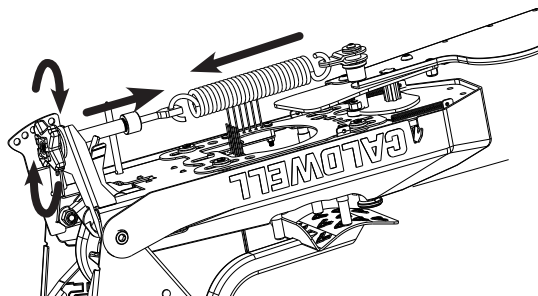

11. Rotate the HEAD ASSEMBLY to the desired angle and fully insert the TILT LOCK PIN. Make sure the TILT LOCK PIN is fully installed. After the TILT LOCK PIN is installed, try to pull the HEAD ASSEMBLY up or down. If the HEAD ASSEMBLY moves freely, the TILT LOCK PIN is not properly installed and the HEAD ASSEMBLY is not properly locked. Recheck the placement of the TILT LOCK PIN.

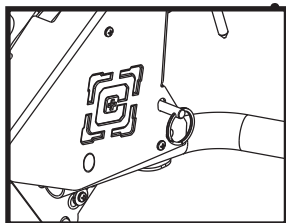
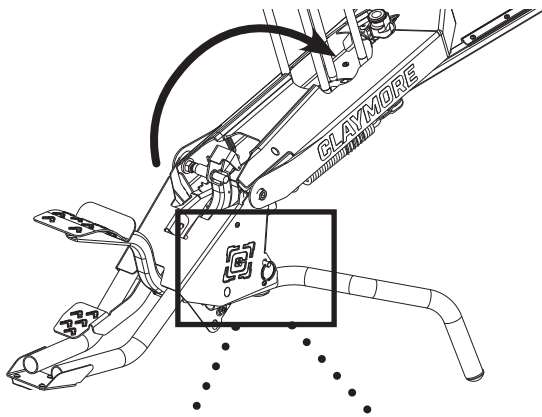

TILT LOCK PIN INSTALLED  
INCORRECTLY

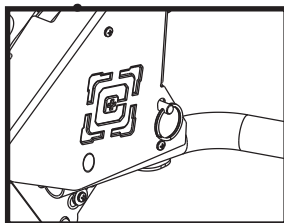

TILT LOCK PIN INSTALLED  
CORRECTLY

# SETUP

- Place the CLAY HOPPER on the four pins with the horseshoe opening toward the front of the Claymore. Press down firmly to properly seat the CLAY HOPPER on the pins. Make sure the CLAY HOPPER is fully seated on the pins.

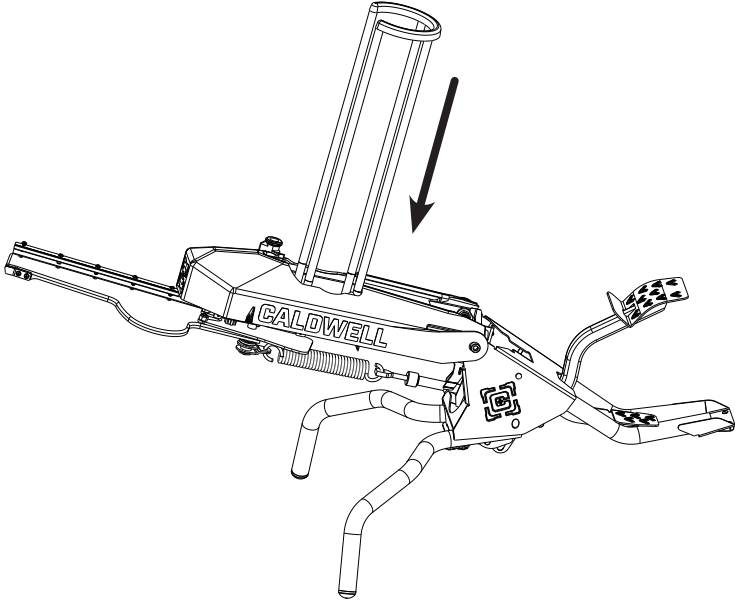

- Lift the SERVICE KNOB and rotate it to the *operate* position (if not already in that position). Then push the knob down to ensure it is in place.

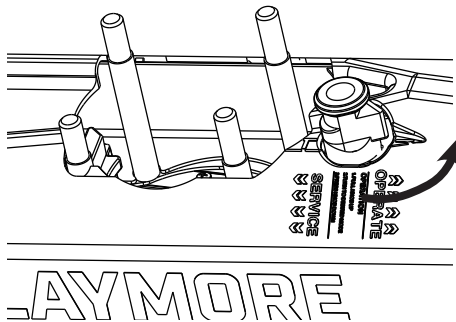

# OPERATION

## LOADING CLAYS

**⚠ WARNING: SERIOUS INJURY MAY OCCUR IF CLAYS ARE LOADED OR HANDS ARE NEAR THE ARMS PATH WITHOUT A FULLY INSERTED SAFETY PIN.**

**⚠ WARNING: ALWAYS REMAIN BEHIND THE CLAYMORE AND OUT OF THE PATH OF THE ARM WHILE LOADING CLAYS.**

**⚠ WARNING: DO NOT LOAD CLAYS WHEN THE THROWING ARM IS IN THE FULLY COCKED POSITION (I.E., WHEN THE THROWING ARM IS UNDER THE MAIN PART OF THE CLAYMORE).**

1. Stand behind the Claymore and out of the path of the THROWING ARM while loading clays.
2. Install the SAFETY PIN (**NOTE: press firmly to ensure full engagement**).
3. Place USA standard clays in the CLAY HOPPER dome side up.
4. Remove the SAFETY PIN.

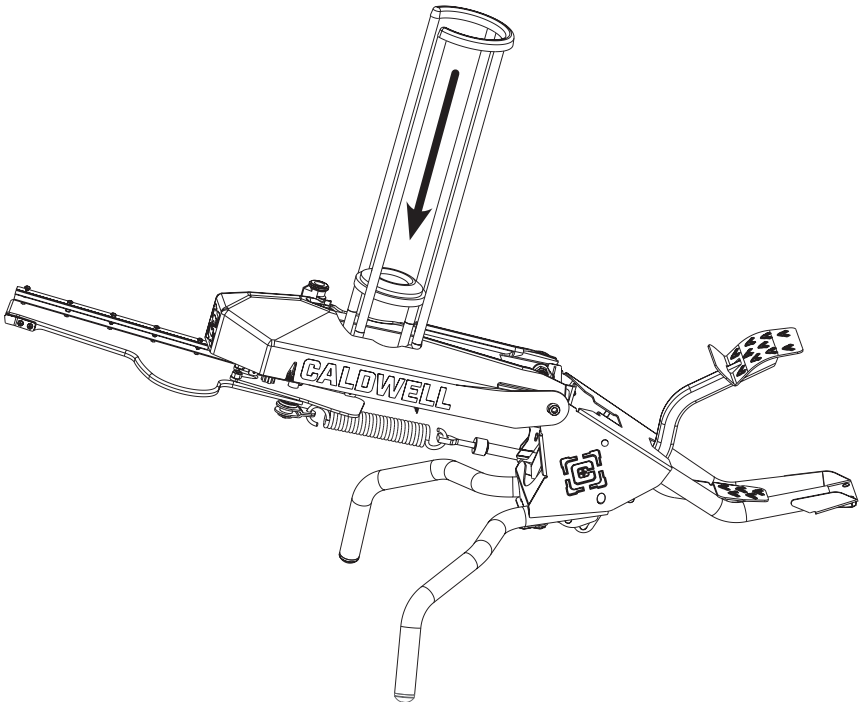

**NOTE:** For reliability and ease of loading clays, keep a minimum of 7 clays in the CLAY HOPPER while in use.

**NOTE:** The Claymore works with USA standard (108 mm) and 110 mm clays. It is not compatible with any other sizes (e.g., rabbit, midi, mini).

# OPERATION

## THROWING CLAYS

**⚠ WARNING: DO NOT SWITCH MODES WHILE THE CLAYMORE IS FULLY CHARGED (I.E., WHEN THE THROWING ARM IS UNDER THE MAIN PART OF THE CLAYMORE). DOING SO MAY THROW A CLAY UNEXPECTEDLY.**

**NOTE:** For best results in either mode, press the CHARGE PEDAL smoothly without excessive force. Stomping on the pedal will result in broken clays and, over time, shorten the life of the Claymore.

**NOTE:** When the Claymore is first unfolded, it will take 2 presses of the CHARGE PEDAL to fully charge the Claymore.

### Manual Mode

- Manual Mode is selected by rotating the FLURRY SELECTOR backward.
1. Press the CHARGE PEDAL to charge the Claymore.
  2. Press the FIRE PEDAL to throw a clay.

### Flurry Mode

- Flurry Mode is selected by rotating the FLURRY SELECTOR forward making the *Flurry* label visible.
1. Press the CHARGE PEDAL to charge the Claymore.
  2. Release the CHARGE PEDAL quickly to throw a clay. Releasing the charge pedal slowly may cause Flurry Mode malfunction.

## UNLOADING CLAYS

**⚠ WARNING: DO NOT LOAD OR UNLOAD CLAYS WITHOUT THE SAFETY PIN INSTALLED OR WHILE FULLY CHARGED (WHEN THE THROWING ARM IS UNDER THE MAIN PART OF THE CLAYMORE). DOING SO MAY RESULT IN INJURY OR DEATH.**

1. Ensure the Claymore is not charged.
2. Install the SAFETY PIN (**NOTE: press firmly to ensure full engagement**).
3. Lift the clays out of the CLAY HOPPER.

# OPERATION

## ADJUSTING THE THROWING DISTANCE AND ANGLE

### Removing Main Spring Tension

1. Make sure the FLURRY SELECTOR is rotated down to manual mode.
2. Insert the SAFETY PIN (**NOTE: press firmly to ensure full engagement**).
3. Push the CHARGE PEDAL to fully charge the Claymore (i.e., when the THROWING ARM is under the main part of the Claymore).
4. Stand behind the Claymore and move the SERVICE KNOB to *service*.  
**NOTE:** *Lift the knob, rotate, and push back down.*
5. Remove the SAFETY PIN.
6. Push the FIRE PEDAL to release the arm. The THROWING ARM will rest in the fully extended position.
7. Move the SERVICE KNOB back to the *operate* position.

### Throwing Distance Adjustment

The throwing speed and distance can be changed by adjusting the MAIN SPRING tension.

1. Remove the MAIN SPRING tension (reference section above).
2. Insert the SAFETY PIN (**NOTE: press firmly to ensure full engagement**).
3. Remove any clay targets from the CLAY HOPPER.
4. Holding the HEAD ASSEMBLY with one hand, remove the TILT LOCK PIN with your other hand.
5. Rotate the HEAD ASSEMBLY back.
6. Use the TENSION KNOB to adjust the spring tension. Turning the TENSION KNOB clockwise increases distance the clays will be thrown, while turning the TENSION KNOB counterclockwise decreases the distance.
7. After adjustment, return the head of the Claymore to the upright position and use the TILT LOCK PIN to lock in desired angle.
8. Load clays into the CLAY HOPPER.
9. Remove SAFETY PIN.

### Throwing Angle Adjustment

1. Remove the MAIN SPRING tension (reference the section at the top of this page).
2. Insert the SAFETY PIN (**NOTE: press firmly to ensure full engagement**).
3. Holding the HEAD ASSEMBLY with one hand, remove the TILT LOCK PIN with your other hand.
4. Rotate the HEAD ASSEMBLY to the desired angle and re-install the TILT LOCK PIN.
5. After the TILT LOCK PIN is installed, try to pull the HEAD ASSEMBLY up or down. If it moves freely, the HEAD ASSEMBLY is not properly locked. Recheck the placement of the TILT LOCK PIN (reference page 10).
6. Remove SAFETY PIN.

# STORAGE

## FOLDING

**⚠ WARNING: DO NOT ATTEMPT TO FOLD THE CLAYMORE UNTIL MAIN SPRING TENSION HAS BEEN REMOVED AND SAFETY PIN IS INSTALLED.**

1. Remove MAIN SPRING tension (reference page 14).
2. Insert the SAFETY PIN (**NOTE: press firmly to ensure full engagement**).
3. Lift clays out of the CLAY HOPPER.
4. Remove the CLAY HOPPER.
5. Hold the HEAD ASSEMBLY with one hand and remove the TILT LOCK PIN.
6. Rotate the HEAD ASSEMBLY of the Claymore back.
7. Loosen the TENSION KNOB by turning it counterclockwise until the TENSION ROD can move freely.
8. Once the TENSION ROD is loose, rotate the THROWING ARM clockwise until it is resting on the ARM STOP.
9. Rotate the entire Claymore over so it rests on the HEAD ASSEMBLY.
10. Loosen the LEG KNOB and move the leg-retaining plate so the legs can be folded.
11. Fold the legs over the Claymore (the leg with the strap should be placed on top of the other leg).
12. Lock the LEG STRAP on the LATCHING PEG.
13. Rotate the leg-retaining plate back to its original position and tighten the LEG KNOB.

## TRANSPORTING

**⚠ WARNING: IF CARRIED UNFOLDED, THE SAFETY PIN MUST BE INSTALLED AND THE THROWING ARM CANNOT BE IN THE COCKED POSITION (I.E., WHEN THE THROWING ARM IS UNDER THE MAIN PART OF THE CLAYMORE). NOT DOING SO MAY RESULT IN INJURY OR DEATH.**

**⚠ WARNING: DO NOT TRANSPORT THE CLAYMORE IN A VEHICLE UNFOLDED. DOING SO MAY RESULT IN INJURY, DAMAGE TO THE CLAYMORE, OR DEATH.**

- Fold the Claymore for transport (reference section above). The Claymore should be properly secured when transporting in a vehicle to avoid damaging the Claymore or the vehicle.

## STORING

- Store the Claymore indoors in an area without excessive humidity.
- Do not stack items on top of the Claymore or allow pressure to be applied to the THROWING ARM while stored.
- Always remove the MAIN SPRING tension before storing the Claymore (reference page 14).

# TROUBLESHOOTING

## THE ARM DOES NOT ROTATE WHEN EXPECTED

1. Verify that the safety pin has been removed.
2. If in Flurry Mode, begin by pressing the FIRE PEDAL. If operating in Manual Mode continue to step 3.
  - If this causes the arm to rotate, verify that the Claymore is still in Flurry Mode. If a clay is still not released switch to Manual Mode and continue to step 3.
  - In Flurry Mode, allow the CHARGE PEDAL to quickly return to the upward position. Releasing the CHARGE PEDAL slowly may cause Flurry Mode to malfunction.
3. Press the CHARGE PEDAL again.
  - If the arm does not rotate, continue to step 4.
  - If the arm rotates, cycle the Claymore again. If the issue does not continue, return to normal operation. If the issue repeats itself, continue to step 6.
4. Press the FIRE PEDAL. If the arm rotates, return to normal operation. Otherwise, continue to step 5.
5. Hold the FIRE PEDAL down and apply moderate force to the CHARGE PEDAL.
  - If the arm rotates, cycle the Claymore again. If the issue does not continue, return to normal operation. If the issue repeats itself, continue to step 6.

**⚠ WARNING: INSTALL THE SAFETY PIN (PROCEEDING TO THE NEXT STEP WITHOUT THE SAFETY PIN INSTALLED MAY CAUSE INJURY OR DEATH).**

6. Remove the TILT LOCK PIN and flip the HEAD ASSEMBLY back.
7. Remove tension from the spring by rotating the TENSION KNOB counterclockwise.

**⚠ WARNING: KEEP HANDS AWAY FROM THE MAIN SPRING AND PINCH POINTS.**

**NOTE:** When the TENSION ROD reaches the end of its travel it will disengage with a loud bang.

8. Once the MAIN SPRING is no longer tensioned, the SAFETY PIN can be removed.
9. Determine what caused the THROWING ARM to become stuck. It is likely that the THROWING ARM is bent. If the THROWING ARM is bent, straighten the THROWING ARM so that the bottom of the THROWING ARM is between the two grooves indicated below.

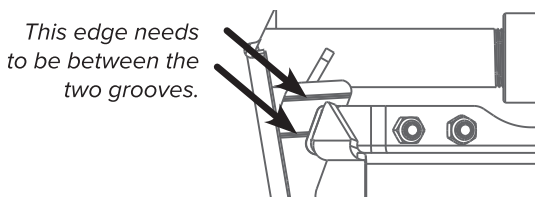

# TROUBLESHOOTING

## EXCESSIVE BROKEN TARGETS

### Low Quality or Wrong Targets

- Targets that have been wet or stored in high humidity may not throw well.
- The Claymore works with USA standard (108 mm) clays. It is not compatible with any other sizes (e.g., rabbit, midi, mini, 110 mm).
- Some target manufacturers package clays with glue drips down the sides. The glue must be removed before the targets can be thrown.

### High Spring Tension

If the MAIN SPRING tension is set too high many clays will be broken. Reduce the MAIN SPRING tension by following step 10 on page 10. Test by throwing a few clays and then increase the tension slowly. If an excessive number of clays are broken before the distance reaches 50 yards, something else is wrong. Continue to review the steps in this section.

### Debris Lodged Under the Arm Bumper

Debris can become lodged under the arm bumper and break the clays before flight. Clearing the debris will solve this problem.

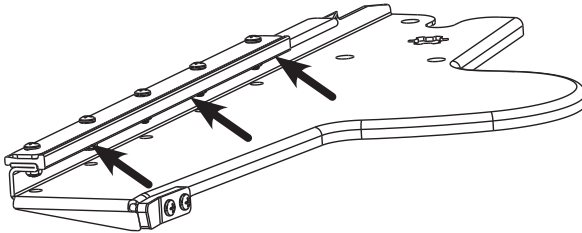

### Bent Brushes

Bent brushes will cause the clays to break during feeding or when thrown.

1. Remove the MAIN SPRING tension and install the SAFETY PIN (**NOTE: press firmly to ensure full engagement**).
  2. Bend the brushes so are approximately as shown in the left image below.
- If the brushes are worn or damaged, they may need to be replaced (reference page 19-20).

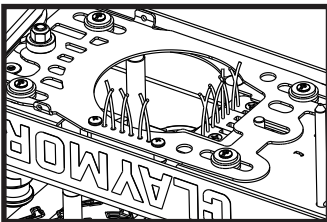

CORRECT

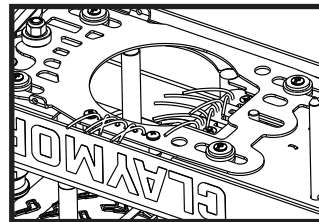

INCORRECT

# TROUBLESHOOTING

## Damaged Arm Bumper

Small pieces of debris stuck in the arm bumper can cause broken targets.

- Remove the debris and test the Claymore.
- If the issue continues, replacing the arm bumper may be necessary.

## Worn or Damaged Wear Components

If the Claymore slowly begins to break more clays over time, replacing worn out components maybe necessary. The parts of the Claymore that experience the most wear after extensive use include: the arm bumper, the brushes, the clay retainer and the ARM STOP damper. Follow the steps in the maintenance section to replace those components.

## SQUEAKING JOINTS

The Claymore does not require routine oiling. If squeaks occur, a drop or two of light oil at the location of the squeak can help solve the issue.

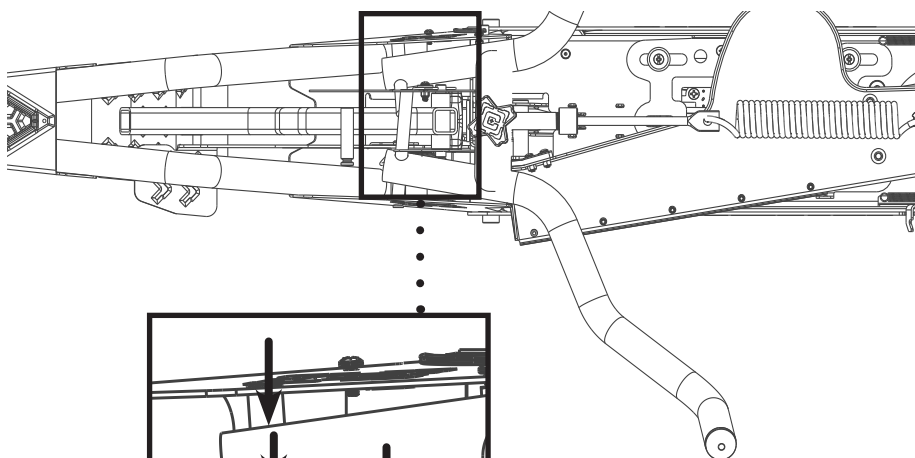

*The oiling locations are indicated by the arrows. Oiling other locations is not advised.*

# MAINTENANCE

**NOTE:** The Claymore should be unfolded before starting maintenance.

## REPLACING THE SIDE BRUSHES

1. Ensure the MAIN SPRING is not tensioned. Remove the MAIN SPRING tension if necessary (reference page 14).
2. Position the THROWING ARM approximately as shown. Using an 8mm wrench and a #2 Phillips head screwdriver remove the two screws. The head can be tilted back or forward for this step.

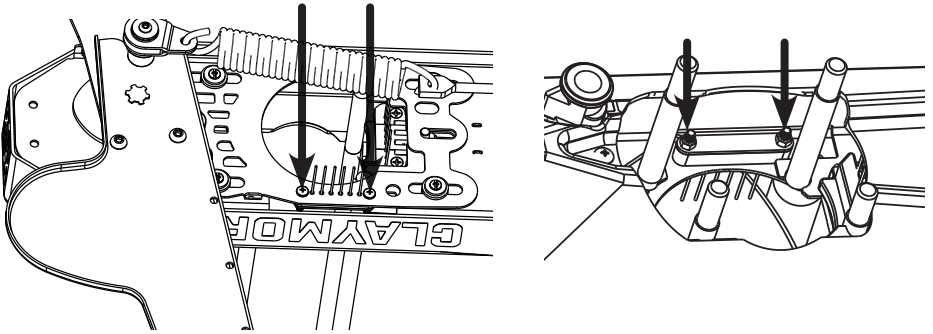

3. Remove the brush holder and top plate.
4. Remove the brushes from the brush holder (reference image below).

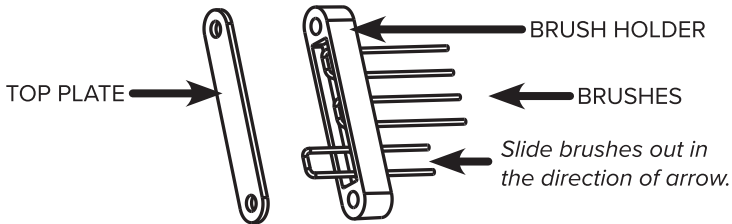

5. Install the new brushes into the brush holder.
6. Re-install the brush holder, making sure each brush goes through the correct hole.
  - Straightening the brushes will make this process easier.
  - Start all brushes before lowering the holder all the way down.

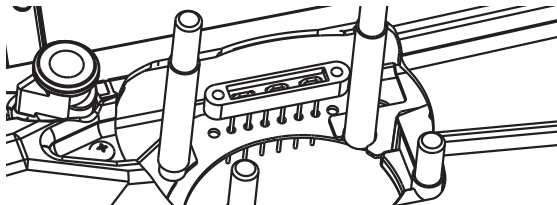

# MAINTENANCE

7. Re-install the top plate over the brush holder and then install the two screws.
  - The #2 Phillips head should be on the bottom (reference page 19).

## REPLACING THE BACK BRUSHES AND CLAY RETAINER

1. Ensure the MAIN SPRING is not tensioned, remove tension if necessary (reference page 14).
2. Position the arm approximately as shown below.
3. Using an 8mm wrench and a #2 Phillips head screwdriver, remove the two screws. The head can be tilted forward or back for this step.

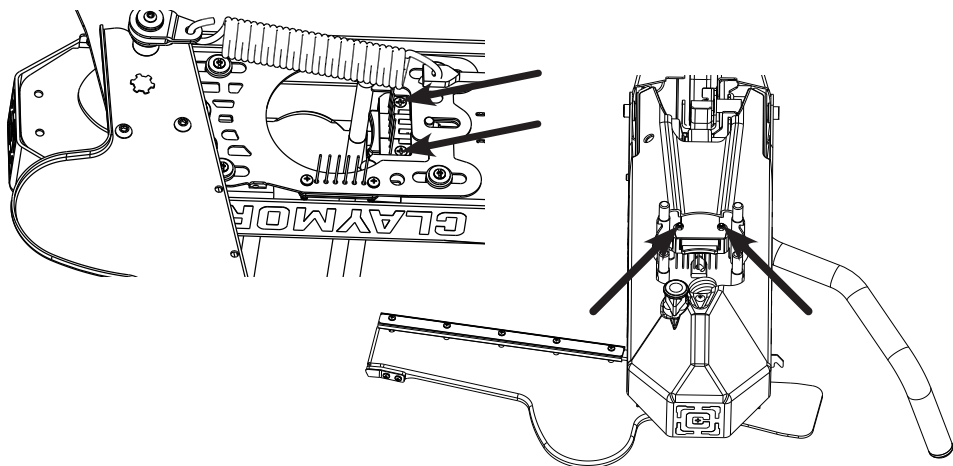

4. Remove the top plate to expose the clay retainer.

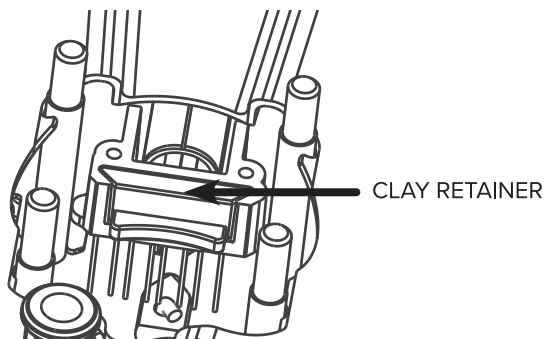

# MAINTENANCE

5. Remove the clay retainer by sliding it upwards.

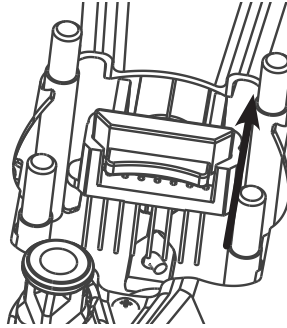

6. Remove the brushes and replace with new ones by sliding the old brushes out and the new brushes back in.

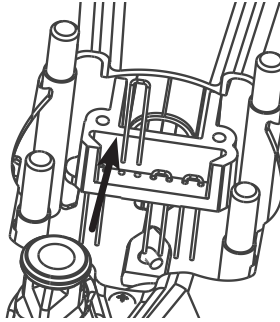

7. Install a new bumper (or use the old one if it is still in working condition). Make sure it is oriented correctly as shown below.

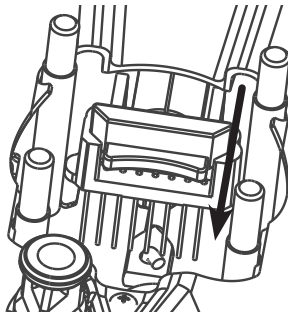

8. Re-install the top plate and screws. The #2 Phillips head should be on the bottom (reference page 20).

# MAINTENANCE

## REPLACING THE ARM BUMPER

1. Ensure that the MAIN SPRING is not tensioned (reference page 14).
2. Position the arm so the 5 screws can be accessed.

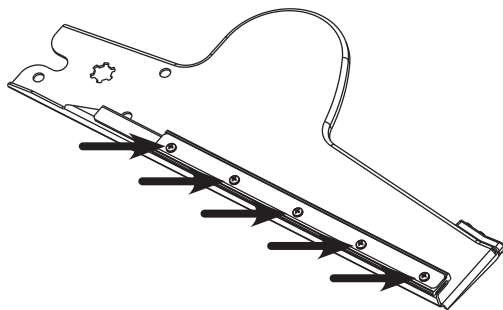

3. Using a #2 Phillips head screwdriver and a 7mm wrench remove the 5 screws.
4. Remove the metal top plate and the arm bumper.
5. Install the new arm bumper, as shown below.



6. Install the metal top plate. Make sure to orient the top plate, as shown below.

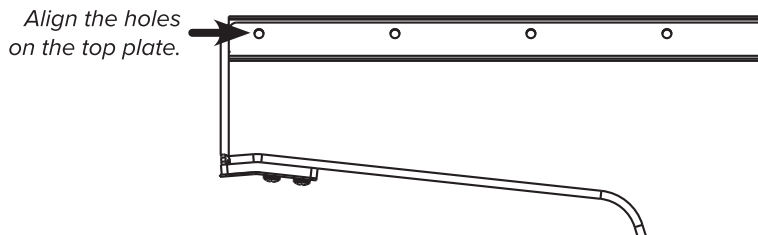

# MAINTENANCE

7. Re-install the nut and screws. Tighten the screws until the end of the screw is flush with the end of the nut. Then tighten the screw an additional  $1\frac{1}{2}$  rotations.

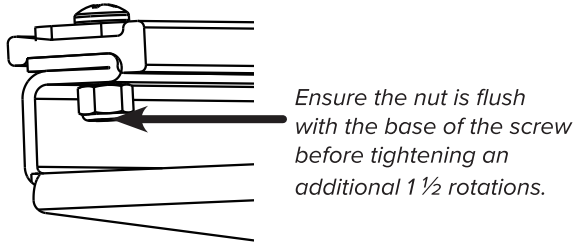

## REPLACING ARM STOP DAMPER

1. Remove the screws using a #2 Phillips head screwdriver and a 7mm wrench.

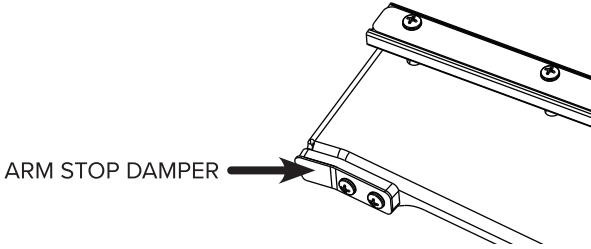

2. Remove the metal shield and rubber damper.
3. Remove the aluminum spacers from the rubber damper.

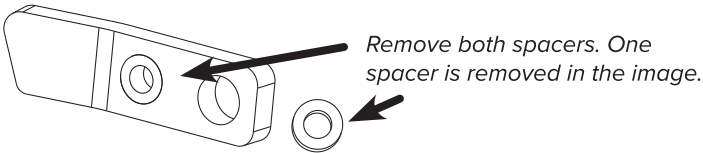

4. Install both spacers into the new rubber damper.
5. Re-install the rubber damper and shield (reference step 1 of this section), then firmly tighten the screws.

Product #1122187  
Instructions #1175609 Ver. 002



1800 N. Route Z, Suite A, Columbia, MO 65202  
[www.aob.com](http://www.aob.com)

Please visit [www.caldwellshooting.com/warranty-info.html](http://www.caldwellshooting.com/warranty-info.html) or contact Customer Service at 1-833-784-5520 for complete warranty terms and conditions.

For purchasing replacement parts, please contact Caldwell Customer Service

**NOT WARRANTED AGAINST MISUSE, ABUSE, OR COMMERCIAL USE.**