

MUF018011112

TACTICAL LASER SIGHT

U n l e a s h T h e G l o w



NEW GEN

TACTICAL LASER SIGHT

U n l e a s h T h e G l o w

OWNER'S MANUAL

For Model: SCP-LS268
SCP-LS278
SCP-LS269
SCP-LS279





CAUTION!

If you need to mount the laser sight onto a firearm, make sure firearm is not loaded before installation. Remove magazine and examine chamber.

Always use safe handling procedures at all times.

Avoid direct eye exposure to laser beam and keep out of reach of children.

Do not direct laser beam toward any person, aircraft, public transportation or other objects with safety concerns.

Examine battery quality and appearance before use each time and make sure that there is no leaking or any deformation. Dispose appropriately if there is a problem.

The batteries are pre-charged by the manufacturer, and cannot be recharged. Recharging can cause battery leakage or, in some cases, high-pressure rupture. Inadvertent charging can occur if a battery is installed backwards.

Install batteries by aligning the + and – signs marked on the battery with the + and 1 signs marked on the battery chamber in the laser sight.

Never use non-rechargeable and rechargeable batteries together in a laser sight. Always replace batteries with the exact type and size specified for the laser sight.

Turn off the laser sight when not in use to conserve battery power.

Always remove batteries from laser sight after use. Leaving battery in the laser sight without use for long period of time may cause damage or danger.

Always replace the whole set of batteries at the same time. Never mix new and used batteries in the same laser sight.

Never deliberately short circuit batteries. Prolonged short circuit will cause the battery to lose energy and result in significant temperature increase.

Do not carry laser sight with batteries installed in the car trunk while driving.

Keep battery compartment clean and keep any metallic object away from the battery.

Lithium batteries can explode or cause burns if disassembled, shorted, recharged, exposed to water, fire, or high temperatures. Do not place loose batteries in a pocket, purse, or other container containing metal objects. Do not mix new with used batteries or mix required batteries with other types of battery. Do not store batteries with hazardous or combustible materials. Store in cool, dry, ventilated area. Follow applicable laws and regulations for disposal.



Avoid direct eye exposure and keep out of reach of children.
Do not direct laser beam toward any person, aircraft, public transportation or other objects with safety concerns.

Component Illustration For SCP-LS269, SCP-LS279

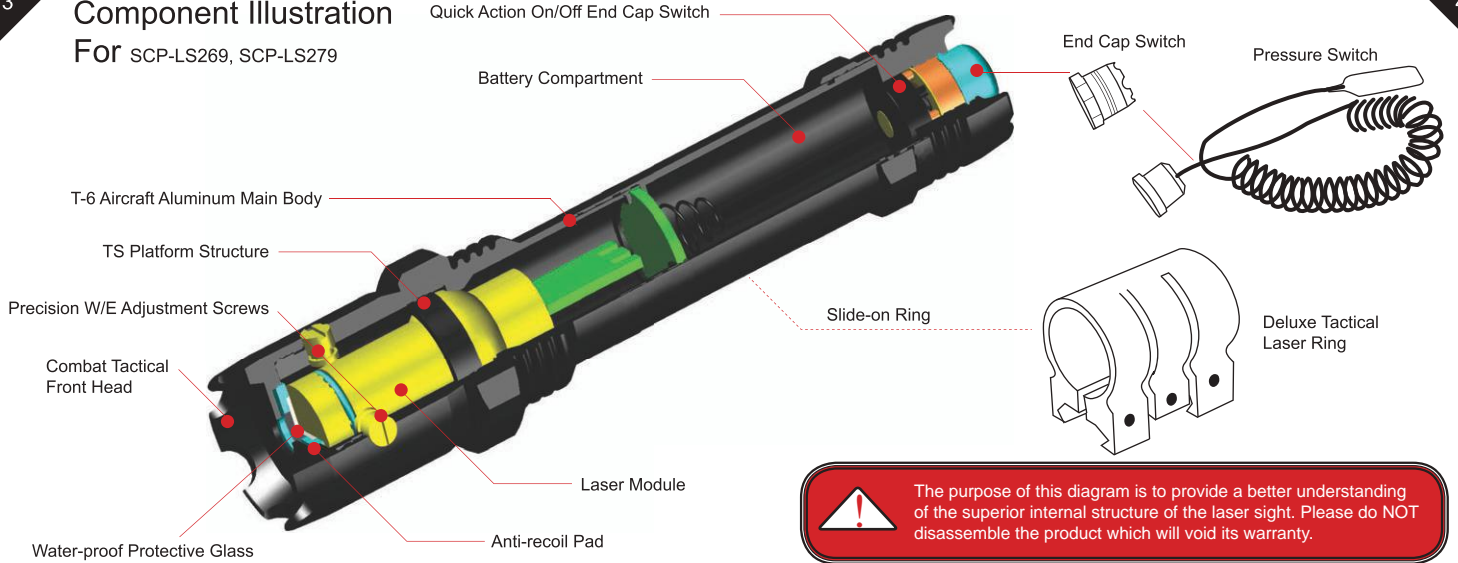

 The purpose of this diagram is to provide a better understanding of the superior internal structure of the laser sight. Please do NOT disassemble the product which will void its warranty.

Component Illustration For SCP-LS268, SCP-LS278

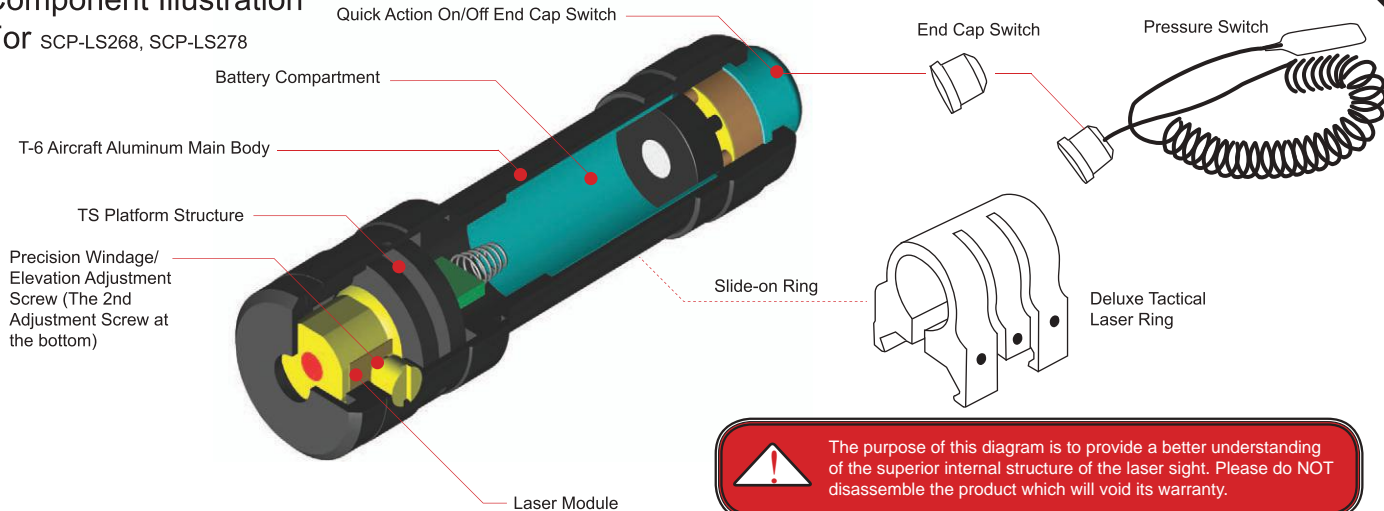





Specification

Item Number	SCP-LS268	SCP-LS278	SCP-LS269	SCP-LS279
Length	2.64"	1.95"	4.6"	3.36"
Main Body Diameter	0.55"	0.47"	0.79"	0.79"
Weight (with Battery)	1 oz	0.5 oz	3.2 oz	2.0 oz
Structure & Adjustment	TS & 4 Points	TS & 3 Points	TS & 4 Points	TS & 3 Points
W/E Adjustment Range	31.5" @ 11yds	31.5" @ 11yds	31.5" @ 11yds	31.5" @ 11yds
Type	CLASS 3R	CLASS 3R	CLASS 3R	CLASS 3R

Output Power	2.0 ~ 4.0mW	2.0 ~ 4.0mW	2.0 ~ 4.5mW	2.0 ~ 4.5mW
Wavelength	630 ~ 640nm	640 ~ 660nm	522 ~ 542nm	522 ~ 542nm
Beam Diameter	0.6" ~ 0.8" @16 yds (75°F ~ 79°F)	0.6" ~ 1.0" @16 yds (75°F ~ 79°F)	0.6" ~ 0.8" @16 yds (75°F ~ 79°F)	0.6" ~ 0.8" @16 yds (75°F ~ 79°F)
Operating Temperature	14°F ~ 104°F	14°F ~ 104°F	59°F ~ 95°F	59°F ~ 95°F
Battery	LR44 x 4	LR48 x 3	CR123A x 1	CR2 x 1
Battery Operating Time	80 mins	45 mins	360 mins	200 mins
Laser Beam Life Time	8000 hrs	3000 hrs	8000 hrs	8000 hrs

Replacement Parts

Contact your flashlight distributor for the following replacement parts:

		
RG-LS861	BAT-LIT880	BAT-NEFL3
Tactical Slide-on Ring for SCP-LS268	1 PC Set of CR123A Lithium Batteries for SCP-LS269	4 PC Set of LR44 Button Batteries for SCP-LS268
		
RG-LS269	BAT-LIT750	BAT-NEFL2
Tactical Slide-on Ring for SCP-LS269	1 PC Set of CR123A Lithium Batteries for SCP-LS279	3 PC Set of LR48 Button Batteries for SCP-LS278

Instruction

Battery Installation

- Unscrew the End Cap Switch or the Pressure Switch.
 - For SCP-LS268, install 4 AG13 or LR44 alkaline button cell batteries following the direction in (Fig1-1).
 - For SCP-LS278, install 3 AG5 or LR48 alkaline button cell batteries following the direction in (Fig1-1).
 - For SCP-LS269, install 1 CR123A lithium battery with the positive pole facing the End Cap Switch (Fig1-2).
 - For SCP-LS279, install 1 CR2 lithium battery with the positive pole facing the End Cap Switch (Fig1-2).
- Replace the End Cap Switch or the Pressure Switch.

Mounting the Laser

- Remove the End Cap Switch or the Pressure Switch from the laser sight (Fig2-1).
- Slide the Laser Ring onto the laser sight and replace the End Cap Switch or the Pressure Switch (Fig2-2).
- Hold the ring and turn the laser to establish proper positions for windage and elevation adjustment screws. Tighten the Middle Screw on the ring to ensure a firm grip on the laser sight. (Fig2-3).
- Slide the ring to the mount rail of the rifle or other application (Fig2-4).
- Tighten the Side Screws on the ring to ensure a firm grip on the rail.

WARNING: Do not over tighten the screws as you could cause damage to the laser sight body.

Two Operation Modes

- On-off Switch Operation
 - Tighten the End Cap Switch.
 - Press and release the button in the center of the End Cap Switch to turn on or off the laser sight (Fig.3-1).
- Pressure Switch Operation
 - Separate the End Cap Switch from the from the laser sight.
 - Replace the End Cap Switch with the Pressure Switch and tighten snugly.
 - Press and hold the Pressure Pad in the middle to turn on the laser sight. Release the Pressure Pad to turn off the laser sight (Fig.3-2).



Windage/Elevation Adjustment



Once the Laser Sight is mounted in position, the Adjustment Screw on the top or bottom of the Laser becomes the Elevation Adjustment Screw, and the Adjustment Screw on the side of the Laser becomes the Windage Adjustment Screw.

Stabilize the firearm to minimize any unexpected movement. Fire a test shot. If the impact point of the bullet is exactly in the center of the target, then the Laser Sight is zeroed. Otherwise, it needs to be adjusted based on the bullet impact. To move the laser beam upward/downward, use Allen wrench to rotate the Elevation Adjustment Screw. To move the laser beam left/right, rotate the Windage Adjustment Screw.

Keep test firing and adjusting until achieving zero. Mounting the laser sight.

IMPACT POINT MOVEMENT INSTRUCTION		Adjustment Screw Positions (From Rear of Laser)			
Windage					
Elevation					

Maintenance

Maintain the metal surface of the laser sight by removing any dirt or sand with a soft brush to avoid scratching the finish.

Store the laser sight in a cool dry place when not in use. Be careful to avoid contact with acid, alkaline or corrosive chemicals.

Take the battery out. This insures good working batteries for your laser and prevents battery leakage.

Keep a fresh package of batteries next to your laser. This gives you back-up power for your laser.

Do not store your laser sight in high temperatures. This would damage your laser sight and may result in battery leakage.

Do not attempt to lubricate any part of the laser sight.

Do not disassemble the laser sight other than replacing pressure switch. Do not loosen or remove screws or parts. Any such or similar actions will void the warranty.

One Year Limited Warranty

This warranty covers defects in materials and workmanship of the product, provided that they are purchased from an authorized distributor and purchased and used in the United States. The warranty lasts for a period of one year from the date of original purchase of the product.

You are entitled to rights under this warranty only if you are the original purchaser of the product and have the original purchase receipt. This warranty is not transferable. We will at our option, repair or replace products that do not conform to this warranty. We may use functionally equivalent reconditioned, refurbished, remanufactured, pre-owned or new products or parts.

This warranty is void if:

- the product has been disassembled, tampered with or parts or screws have been removed or loosened; or
- the product has been abused, maliciously damaged, mistreated or used for a purpose contrary to the purpose for which it was designed or the instructions provided with the product.

For Warranty service, please contact your authorized distributor and provide them with a written description of the defect and your original purchase receipt. You must obtain a Return Authorization Number and return procedures with delivery destination before returning the product for repair or replacement.

Disclaimer and Limitation of Liability

Leapers is pleased to offer suggestions of the use of its products, however Leapers neither assumes responsibility for any omissions or errors nor assumes liability for any damages that result from the use of its products in accordance with information provided by Leapers, whether verbal or written.

EXCEPT FOR THE EXPRESS WRITTEN WARRANTY SPECIFICALLY SET FORTH ABOVE, ALL EXPRESS AND IMPLIED REPRESENTATIONS AND WARRANTIES ARE HEREBY DISCLAIMED, INCLUDING ANY IMPLIED WARRANTY OF MERCHANTABILITY, NON-INTERFERENCE, FITNESS FOR A PARTICULAR PURPOSE, NON-INFRINGEMENT, OR WARRANTY OF ACCURACY OF ANY INFORMATION PROVIDED WHETHER WRITTEN OR ORAL. ALL WARRANTIES ARISING FROM ANY COURSE OF DEALING, LAW, USAGE OR TRADE PRACTICE ARE HEREBY EXPRESSLY EXCLUDED TO THE EXTENT ALLOWED BY LAW. TO THE EXTENT AN IMPLIED WARRANTY CANNOT BE EXCLUDED, SUCH WARRANTY IS LIMITED IN DURATION TO ONE YEAR. SOME STATES OR JURISDICTIONS DO NOT ALLOW LIMITATIONS ON HOW LONG AN IMPLIED WARRANTY LASTS, SO THE ABOVE LIMITATION MAY NOT APPLY TO YOU.

UNDER NO CIRCUMSTANCES IS LEAPERS, OR ITS SUPPLIERS OR RESELLERS LIABLE FOR ANY OF THE FOLLOWING EVEN IF INFORMED OF THEIR POSSIBILITY: 1) THIRD PARTY CLAIMS AGAINST YOU FOR DAMAGES; 2) SPECIAL, INCIDENTAL, OR INDIRECT DAMAGES OR FOR ANY ECONOMIC CONSEQUENTIAL DAMAGES; OR 3) LOST PROFITS, BUSINESS REVENUE, GOODWILL, OR ANTICIPATED SAVINGS. SOME STATES OR JURISDICTIONS DO NOT ALLOW THE EXCLUSION OR LIMITATION OF INCIDENTAL OR CONSEQUENTIAL DAMAGES, SO THE ABOVE LIMITATION OR EXCLUSION MAY NOT APPLY TO YOU.